

LEGEND & NOTES

--- SITE BOUNDARY  
Refer Project Survey Drawing

1 ACj M  
EXISTING TREE LOCATION  
Tree Number, Species Code & Tree Management Status

TREE DEAD / NO TREE

KEY TO SPECIES

ACj Acer japonicum  
Sor. Sorbus sp.  
PSs Pistachia chinensis  
FRo Fraxinus oxycarpa  
Ups Ulmus parvifolia  
Psp. Pyrus sp.  
Mat Malus floribunda  
BTp Betula pendula  
Qma Quercus macrocarpa

MANAGEMENT STATUS

- E** EXCELLENT - A TREE OR GROUP OF TREES THAT:
- HAS NATURAL OR CULTURAL HERITAGE IMPORTANCE; OR
  - HAS HIGH AND AESTHETIC VALUE AND WILL CONTRIBUTE SIGNIFICANTLY TO THE SURROUNDING LANDSCAPE; OR
  - IS OF OUTSTANDING FORM AND CONDITION AND IS AN EXCELLENT EXAMPLE OF THE SPECIES; OR
  - HAS SIGNIFICANT SCIENTIFIC VALUE, INCLUDING ECOLOGICAL IMPORTANCE.
- H** HIGH - A TREE THAT:
- IS OF GOOD FORM, STRUCTURE AND HEALTH;
  - IS WITHOUT SIGNIFICANT DEFECT; AND
  - PRESENTS A LOW HAZARD/SAFETY RISK.
- M** MEDIUM - A TREE THAT:
- IS OF REASONABLE FORM, STRUCTURE AND HEALTH; AND
  - PRESENTS A MEDIUM TO LOW HAZARD/SAFETY RISK.
- P** POOR - A TREE THAT:
- IS OF POOR FORM, STRUCTURE OR HEALTH IS IN DECLINE, OR
  - PRESENTS A HIGH OR VERY HIGH HAZARD/SAFETY RISK.

TO BE READ IN CONJUNCTION WITH VEGETATION ASSESSMENT REPORT PREPARED BY  
*dsb Landscape Architects*  
DATED 17/05/2021

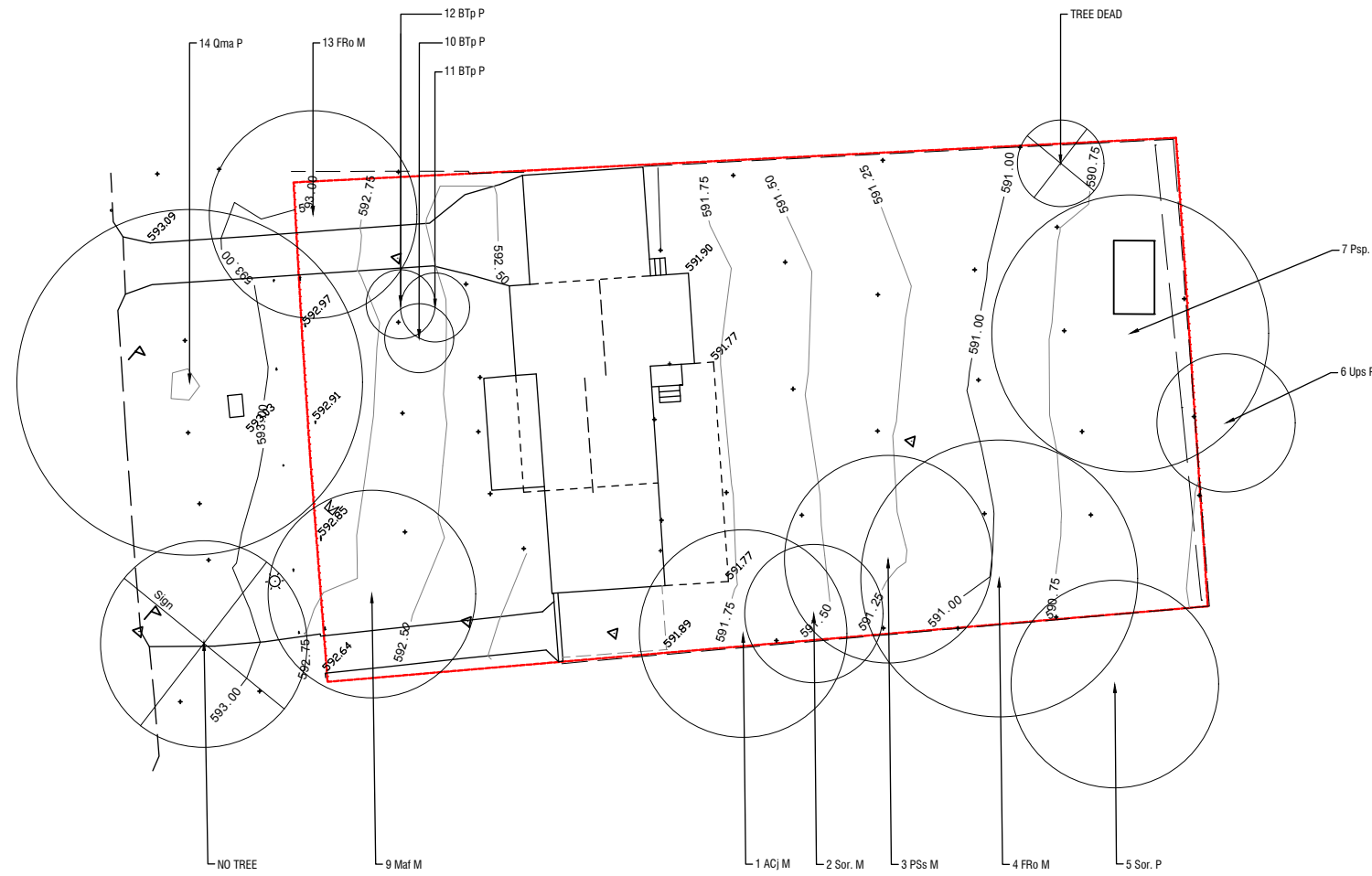

This vegetation assessment has been completed in accordance with the  
Tree Protection Act 2005 Part 4 S31 (Guidelines for Tree Management Plans)

A	MR	YZ	MR	17/05/2021	ISSUE FOR APPROVAL	
NO.	DESIGN	DRAWN	CHECKED	VERD	DATE	AMENDMENT / ISSUE

NOTES  
© COPYRIGHT  
DRAWINGS TO BE READ IN CONJUNCTION WITH THE INFORMATION CONTAINED IN THE ACCOMPANYING VEGETATION ASSESSMENT REPORT.  
TREE LOCATIONS BASED ON SURVEY SUPPLIED BY THE CLIENT.  
DO NOT SCALE FROM DRAWING.

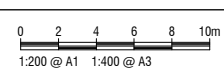

**dsb**  
Landscape Architects  
Deakin Chambers  
14 Hannah Place  
Deakin ACT 2600  
Tel 02 6285 1955  
dsb@dsbla.com.au

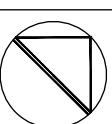

Project  
BLK 14 SEC 2 DP 709  
71 NATIONAL CIRCUIT, DEAKIN  
Client  
COGGAN FAMILY

Drawing Title VEGETATION ASSESSMENT		
Scale	Plot Date:	Sheet No.
Drg. No. 4218-G101 A		1

<b>Company</b>	Coggan Family	<b>Date</b>	17 May 2021
<b>Attention</b>	Melissa and Paul	<b>This Page +</b>	7
<b>From</b>	dsb Landscape Architects	<b>Project No.</b>	4218
<b>Project</b>	71 National Circuit DEAKIN Block 14 Section 2		
<b>Subject</b>	Vegetation Assessment Report		

**dsb Landscape Architects**

14 Hannah Place, Deakin, ACT, 2600  
 02 6285 1955 dsb@dsbla.com.au www.dsbla.com.au

## 1. OVERVIEW

### Introduction

The aim of this report is to provide detailed information on the location and status of trees within the site referred to as Block 14 Section 2 DEAKIN. The information will aid in the development of the site by identifying and assessing trees that are Protected and covered by the Tree Protection Act 2005. This report has been prepared in accordance with the mandatory requirements of the ACTs Tree Protection (Guidelines for Tree Management Plans) Determination 2010.

### Site Description

The site is a residential building located centrally on the block. Large Sorbus weed trees are located both within the block and within the neighbours' lease with Tree Protection Zones overhanging the fence. These tree species are prohibited pest plants and should be removed immediately.

A large Pyrus sp. tree is located in the back yard under the power lines. It has recently lost a large limb with decay in the joint and trunk. Retention of this tree is not recommended.



## 2. MANAGEMENT STATUS INVENTORY

The following represents details recorded for the trees on the site. The information recorded is intended for use in the assessment and management of trees at the nominated location. Refer to Vegetation Assessment drawing 4218-G101.

### 1. Number

Reference number. Each tree/group of trees is numbered to link Plan and Report information, and allow for easy identification in the field.

### 2. Botanical Name/Species

The botanical Name/Species is provided for each tree in the table below:

### 3. Management Status

- E        Excellent –A tree or group of trees that:
- has natural or cultural heritage importance; or
  - has high aesthetic value and will contribute significantly to the surrounding landscape; or
  - is of outstanding form and condition and is an excellent example of the species; or
  - has significant scientific value, including ecological importance.
- H        High - A tree that:
- is of good form, structure and health;
  - is without significant defect; and
  - presents a low hazard/safety risk.
- M        Medium - A tree that:
- is of reasonable form, structure and health; and
  - presents a medium to low hazard/safety risk.
- P        Poor - A tree that;
- is of poor form, structure or health is in decline; or
  - presents a high or very high hazard/safety risk.

### 4. Height

Approximate in metres

## 5. Trunk Circumference

1 metre above ground level, approximate in millimetres.

## 6. Number of Trunks

Number of trunks larger than 150mm diameter measured at 1.0 metre above ground level

## 7. Canopy Diameter

Shown in metres and is the maximum canopy width of the tree. The tree canopy radius, plus 2 metres defines the Tree Protection Zone. Tree Protection ACT 2005 regulates activities within the Tree Protection Zone that have the potential to harm the tree (Prohibited Ground works). Prohibited Ground works includes any ground work under the canopy of the tree that is likely to harm the tree including building, trenching, changing soil levels, compacting or contaminating the soil

## 8. Health

Assessment based on crown and trunk appearance.

E – Excellent	F - Fair
G – Good	P – Poor

## 9. Expected Longevity

S - Short (less than 10 years)  
M - Medium (10 - 25 years)  
L - Long (greater than 25 years)

## 10. Tree Surgery

Recommended short term management action that would be appropriate in the event of changed conditions. Such action may include:

LP	Remove dead wood and light prune to improve form if necessary.
HP	General tree surgery and pruning to remove dead and/or diseased wood, to shape, balance or reduce the crown, to eliminate low growing limbs or other inferior or damaged growth, for management of top heavy or lopsided canopy or corrective work following physical damage or vandalism.
FP	Formative pruning.

All pruning to be in accordance with AS 4373 – ‘Pruning of Amenity Trees’.

## 11. Regulated Tree / Tree Damaging Activity (TDA) Approval:

Under the Tree Protection Act 2005, all trees on leased Territory land are 'Protected' trees until specific Tree Management Precincts are established. Trees that meet any of the following criteria are 'Regulated' trees:

- a) a height of 12 metres or more, or
- b) a trunk circumference of 1.5 metres (approximately 0.5 metres in diameter) or more at 1 metre above ground level, or
- c) two or more trunks and the total circumference of all the trunks, 1 metre above ground level, is 1.5 metres or more, or
- d) a minimum crown width of 12 metres or more.

Trees meeting any of these criteria are indicated.

**Y** – Regulated tree - meets at least one of the criteria.

**N** – Does not meet any of the criteria for a 'Regulated' tree.

The approval of the Conservator is required to remove a Regulated tree.

The approval of the Conservator is required to undertake ground works within the Tree Protection Zone. Approval is sought by the submission of an Application to Undertake a Tree Damaging Activity. Contact the Environment ACT Helpline on 6207 9777 for an application form for Approval to Undertake a Tree Damaging Activity. Forms are also available from the Environment ACT Internet site.

**VEGETATION ASSESSMENT**  
**Block 14 Section 2 DEAKIN**  
**71 National Circuit.**

Tree No.	Species	M'ment Status	Height (m)	Trunk Circ (mm)	Number of Trunks	Canopy Dia (m)	Health	Expected Longevity	Tree Surgery	Regulated Tree	Notes
1	Acer japonicum	M	5	850, 350	2	6	G	L	N/A	N	Good quality landscape tree. Consider for retention in boundary offset landscape zone.
2	Sorbus sp.	M	7	600, 650	2	4	G	L	N/A	N	Weed Tree
3	Pistachia chinensis	M	7	1050	1	6	G	L	N/A	N	
4	Fraxinus oxycarpa	M	7	1450	1	8	G	L	N/A	N	
5	Sorbus sp.	P	6	1500 +	1	6	P	S	FP	N	Weed tree. Neighbours tree with Tree protection Zone extending over the lease boundary
6	Ulmus parvifolia	P	6	600	1	4	P	S	FP	N	Neighbours tree with Tree protection Zone extending over the lease boundary
7	Pyrus sp.	P	8	1600	1	8	P	M	FP	Y	Major limb loss. Evidence of past lopping of branches. Canopy with the electricity wires.
8	Dead										
9	Malus floribunda	M	4	550, 440, 330, 340	4	6	F	M	N/A	N	Fruit Tree
10	Betula pendula	P	4	200	1	2	P	S	FP	N	

**VEGETATION ASSESSMENT**  
**Block 14 Section 2 DEAKIN**  
**71 National Circuit.**

Tree No.	Species	M'ment Status	Height (m)	Trunk Circ (mm)	Number of Trunks	Canopy Dia (m)	Health	Expected Longevity	Tree Surgery	Regulated Tree	Notes
11	Betula pendula	P	7	400	1	2	P	S	FP	N	
12	Betula pendula	P	7	200, 100, 100	3	2	P	S	FP	N	
13	Fraxinus oxycarpa	M	7	950	1	6	F	M	N/A	N	
14	Quercus macrocarpa	P	10	1700	1	10	P	M	LP		Street tree
15	No Tree										No tree at this location. Street tree removed

### **3. RECOMMENDATIONS**

The following recommendations are made in respect of the development of this site:

Tree 1 *Acer japonicum* is a valuable tree and should be retained.

Tree 2 is a prohibited pest plant and should be removed immediately.

Tree 7 is a poorly performed *Pyrus* sp. and should not be retained.

### **4. NOTES / DISCLAIMER**

#### **LIMITATIONS ON THE USE OF THIS REPORT**

This report is to be utilised in its entirety only. Any written or verbal submission, report or presentation that includes statements taken from the findings, discussions, conclusions or recommendations made in this report, may only be used where the whole of the original report (or a copy) is referenced in, and directly attached to that submission, report or presentation.

#### **UNLESS STATED OTHERWISE**

Information contained in this report covers only those trees that were examined and reflect the condition of those trees at the time of inspection on 14 May 2021.

The inspection was limited to visual examination of the subject trees without dissection, excavation, probing or coring. There is no warranty or guarantee, expressed or implied, that problems or deficiencies of the subject trees may not arise in the future. The findings of this report may not necessarily agree with reports prepared by others, including the Government Conservator of Trees.

### **5. QUALIFICATIONS**

This Vegetation Assessment Report has been prepared by



Michael Reeves

Registered Landscape Architect AILA #486





## 6. QUALITY ASSURANCE

### Contact information:

DSB Partners Pty Ltd  
Trading as dsb Landscape Architects  
ABN 94 052 528 293

Directors: Adam Barker, David Pearce and Michael Reeves

Deakin Chambers  
14 Hannah Place  
Deakin ACT 2600

Phone: (02) 6285 1955

Email: dsb@dsbla.com.au

Web: www.dsbla.com.au

### Quality assurance information

Report title: Vegetation Assessment B14 S2 DEAKIN

Job number: 4218

Date: 17 May 2021

Prepared by: Michael Reeves

Reviewed by: David Pearce

### Issue history

Issue Number	Issue Date	Details	Authorised by
1	17 May 2021	Vegetation Assessment	Dp

