

CANBERRA LIGHT RAIL 2A

PUBLIC DOMAIN GENERAL ARRANGEMENT

| DRAWING INDEX | | |
|--------------------------|--|----------|
| DRAWING NUMBER | DESCRIPTION | |
| | PACKAGE 80 - PUBLIC DOMAIN | |
| | PUBLIC DOMAIN GENERAL ARRANGEMENT | |
| | | |
| S210-ACM-DRW-LAN-NA-0002 | COVER AND DRAWING INDEX | SHEET 1 |
| S210-ACM-DRW-LAN-NA-0010 | KEY PLAN | SHEET 1 |
| S210-ACM-DRW-LAN-NA-0015 | GENERAL NOTES | SHEET 1 |
| S210-ACM-DRW-LAN-NA-0021 | LEGEND | SHEET 1 |
| | | |
| S210-ACM-DRW-LAN-NA-2001 | GENERAL ARRANGEMENT - NORTHBOURNE AV/ALINGA ST | SHEET 1 |
| S210-ACM-DRW-LAN-NA-2002 | GENERAL ARRANGEMENT - NORTHBOURNE AV/LONDON CIRCT | SHEET 2 |
| S210-ACM-DRW-LAN-NA-2003 | GENERAL ARRANGEMENT - LONDON CCT/WEST ROW | SHEET 3 |
| S210-ACM-DRW-LAN-NA-2004 | GENERAL ARRANGEMENT - LONDON CCT/UNIVERSITY AV | SHEET 4 |
| S210-ACM-DRW-LAN-NA-2005 | GENERAL ARRANGEMENT - LONDON CCT/GORDON ST | SHEET 5 |
| S210-ACM-DRW-LAN-NA-2006 | GENERAL ARRANGEMENT - LONDON CCT - EDINBURGH AV STOP | SHEET 6 |
| S210-ACM-DRW-LAN-NA-2007 | GENERAL ARRANGEMENT - LONDON CCT - QT HOTEL | SHEET 7 |
| S210-ACM-DRW-LAN-NA-2008 | GENERAL ARRANGEMENT - LONDON CCT/COMMONWEALTH AV | SHEET 8 |
| S210-ACM-DRW-LAN-NA-2009 | GENERAL ARRANGEMENT - COMMONWEALTH AV - CITY SOUTH STOP | SHEET 9 |
| S210-ACM-DRW-LAN-NA-2010 | GENERAL ARRANGEMENT - COMMONWEALTH AV/PARKES WAY ON RAMP | SHEET 10 |
| S210-ACM-DRW-LAN-NA-2011 | GENERAL ARRANGEMENT - COMMONWEALTH AV - COMMONWEALTH PARK STOP | SHEET 11 |
| S210-ACM-DRW-LAN-NA-2012 | GENERAL ARRANGEMENT - NORTHBOURNE AV/LONDON CIRCT | SHEET 12 |
| S210-ACM-DRW-LAN-NA-2015 | GENERAL ARRANGEMENT - EDINBURGH AV / GORDON ST | SHEET 15 |

| | | | | | |
|-----------------------------|--------------------------------------|------------------------|------------------------|------------------------|--|
| | | | | | |
| D | REFERENCE DESIGN - WORK IN PROGRESS | HC 20.12.22 | SC 20.12.22 | JP 20.12.22 | |
| C | APPROVALS ISSUE | HC 16.12.22 | SC 16.12.22 | JP 16.12.22 | |
| B | CO-ORDINATION SET - WORK IN PROGRESS | HC 04.11.22 | SC 04.11.22 | JP 04.11.22 | |
| A | ALIGNMENT & URBAN DESIGN LOCK | HC 30.09.22 | SC 30.09.22 | JP 30.09.22 | |
| AMD | DESCRIPTION | DESIGNER SIGN./DATE | VERIFIED SIGN./DATE | APPROVED SIGN./DATE | |
| CO-ORDINATE SYSTEM: STROMLO | | HEIGHT DATUM: AHD | SCALE: AS SHOWN | | |



This drawing is confidential and shall only be used for the purpose of this project.
The signing of this title block confirms the design and drafting of this project have been prepared and checked in accordance with the Canberra Light Rail Stage 2 quality assurance system to ISO 9001:2015

AECOM
AECOM Australia Pty Ltd
A.B.N. 20 093 846 925

DRAWN _ _ _ C LANE _ _ _ _ _
DESIGNED _ _ _ H CARLYLE _ _ _ _ _
DRG CHECK _ _ _ A MARTIN _ _ _ _ _
DESIGN CHECK _ _ _ S CALLAGHAN _ _ _ _ _
APPROVED _ _ _ J PETERS _ _ _ _ _

CANBERRA LIGHT RAIL 2A
LANDSCAPE
COVER SHEET AND DRAWING INDEX
GENERAL ARRANGEMENT
SHEET 1

| | | | |
|----------------|--------------------------|-----------------|----|
| DESIGN LOT No: | S210-STAGE2A | SHEET: 01 OF 01 | A1 |
| STATUS: | APPROVALS ISSUE | | |
| DRG No. | S210-ACM-DRW-LAN-NA-0002 | EDMS No. | D |

DRAWING COLOUR CODED - PRINT ALL COPIES IN COLOUR

SCALE @ A1

C:\pwworking\aecom\cs12_aupaul.boyed@aecom\csm\dd142007\S210-ACM-DRW-LAN-NA-0002.dwg

File PlottedS210-ACM-DRW-LAN-NA-0002

Plot Date & Time: 2/9/2023 8:07 PM

Plotted by:BOYLEP

DF 801*554

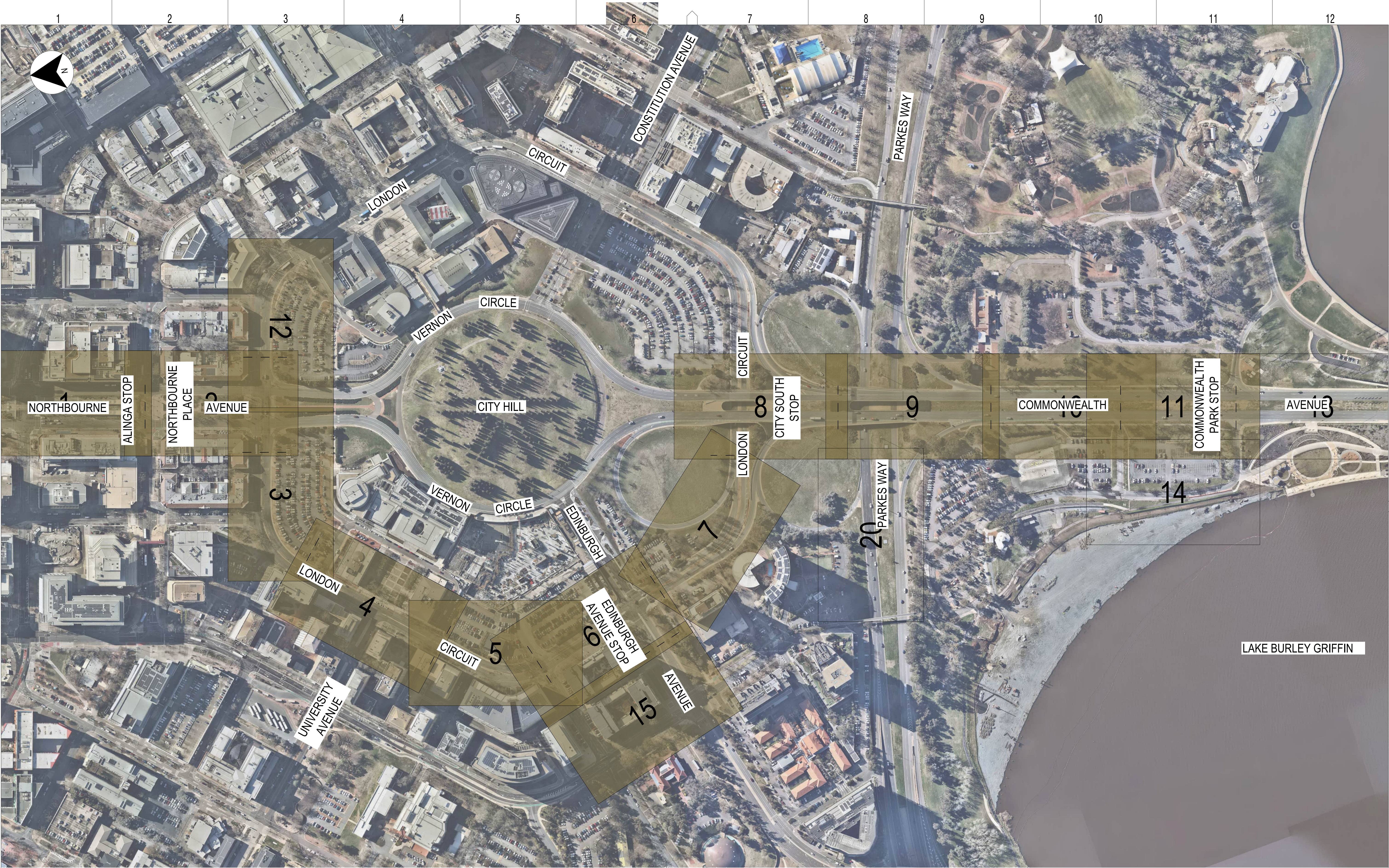

NOT FOR CONSTRUCTION

CANBERRA LIGHT RAIL 2A
LANDSCAPE
KEY PLAN

| | | | |
|----------------|--------------------------|-----------------|----|
| SHEET 1 | | | |
| DESIGN LOT No. | S210-STAGE2A | SHEET: 01 OF 01 | A1 |
| STATUS: | APPROVALS ISSUE | | |
| DRG No. | S210-ACM-DRW-LAN-NA-0010 | EDMS No. | G |

| | | | | |
|-----------------------------|-----------------|------------------------|------------------------|------------------------|
| G | APPROVALS ISSUE | HC 10.02.23 | SC 10.02.23 | JP 10.02.23 |
| F | APPROVALS ISSUE | HC 16.12.22 | SC 16.12.22 | JP 16.12.22 |
| AMD | DESCRIPTION | DESIGNER SIGN./DATE | VERIFIED SIGN./DATE | APPROVED SIGN./DATE |
| CO-ORDINATE SYSTEM: STROMLO | | HEIGHT DATUM: AHD | SCALE: AS SHOWN | |



This drawing is confidential and shall only be used for the purpose of this project.
The signing of this title block confirms the design and drafting of this project have been prepared and checked in accordance with the Canberra Light Rail Stage 2 quality assurance system to ISO 9001:2015



DRAWN C LANE
DESIGNED H CARLYLE
DRG CHECK H ROSSER
DESIGN CHECK S CALLAGHAN
APPROVED J PETERS

20 0 20 40 60 80m
1:2000 FULL SIZE A1
SCALE @ A1

DRAWING COLOUR CODED - PRINT ALL COPIES IN COLOUR

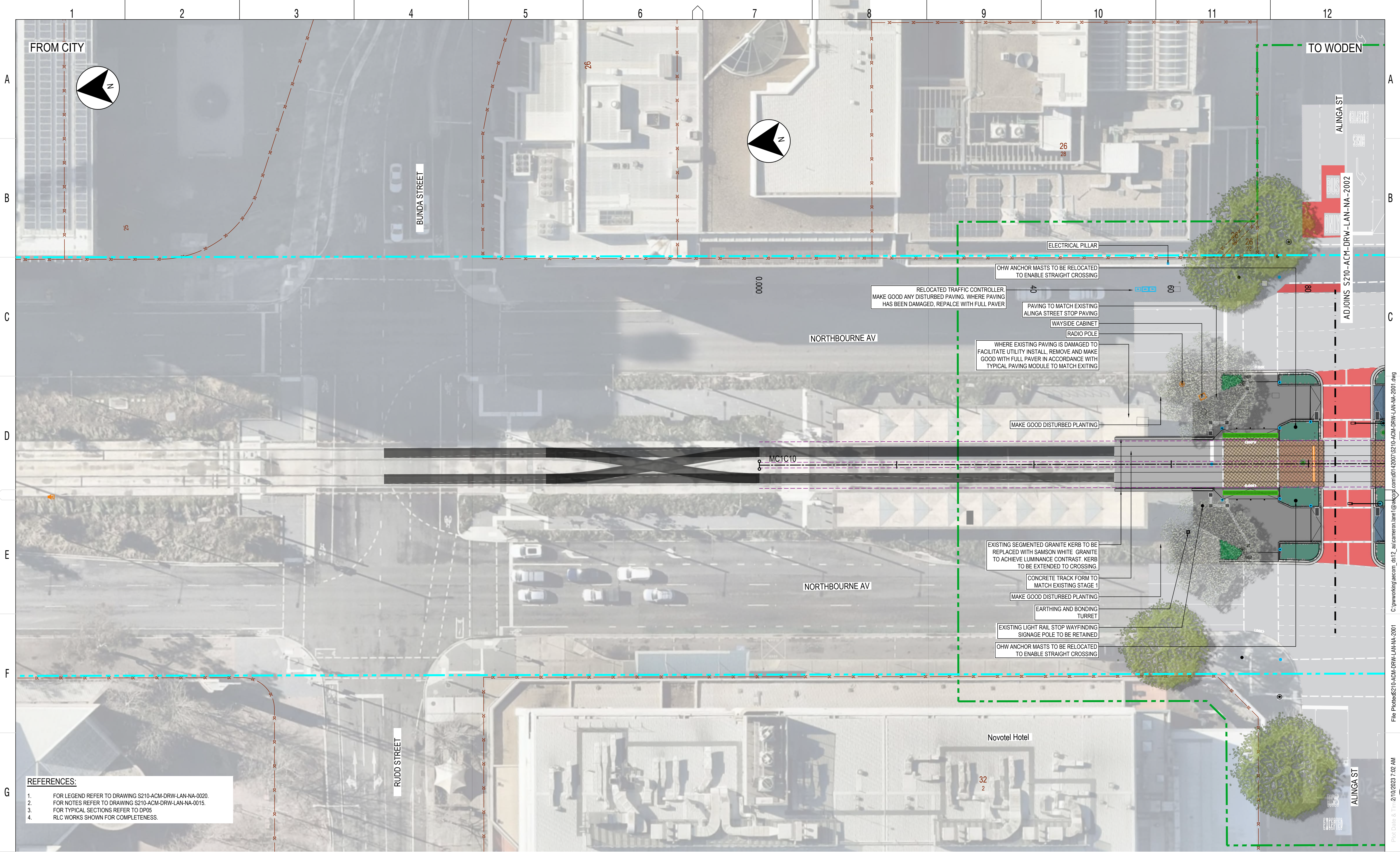

1

2

3

4

5

6

7

8

9

10

11

12

A

B

C

D

E

F

G

H

FROM CITY

TO WODEN

BUNDA STREET

NORTHBOURNE AV

NORTHBOURNE AV

Novotel Hotel

ALINGA ST

ALINGA ST

RUDD STREET

ADJOINS S210-ACM-DRW-LAN-NA-2002

25

26

26

28

26

29

32

2

0000

MC1C10

08

08

RELOCATED TRAFFIC CONTROLLER. MAKE GOOD ANY DISTURBED PAVING. WHERE PAVING HAS BEEN DAMAGED, REPLACE WITH FULL PAVER

PAVING TO MATCH EXISTING ALINGA STREET STOP PAVING

WAYSIDE CABINET

RADIO POLE

WHERE EXISTING PAVING IS DAMAGED TO FACILITATE UTILITY INSTALL, REMOVE AND MAKE GOOD WITH FULL PAVER IN ACCORDANCE WITH TYPICAL PAVING MODULE TO MATCH EXISTING

MAKE GOOD DISTURBED PLANTING

ELECTRICAL PILLAR

OHV ANCHOR MASTS TO BE RELOCATED TO ENABLE STRAIGHT CROSSING

EXISTING SEGMENTED GRANITE KERB TO BE REPLACED WITH SAMSON WHITE GRANITE TO ACHIEVE LUMINANCE CONTRAST. KERB TO BE EXTENDED TO CROSSING

CONCRETE TRACK FORM TO MATCH EXISTING STAGE 1

MAKE GOOD DISTURBED PLANTING

EARTHING AND BONDING TURRET

EXISTING LIGHT RAIL STOP WAYFINDING SIGNAGE POLE TO BE RETAINED

OHV ANCHOR MASTS TO BE RELOCATED TO ENABLE STRAIGHT CROSSING

REFERENCES:

1. FOR LEGEND REFER TO DRAWING S210-ACM-DRW-LAN-NA-0020.

2. FOR NOTES REFER TO DRAWING S210-ACM-DRW-LAN-NA-0015.

3. FOR TYPICAL SECTIONS REFER TO DP05

4. RLC WORKS SHOWN FOR COMPLETENESS.

KEY PLAN

SCALE 1:250

SCALE @ A1

DRAWING COLOUR CODED - PRINT ALL COPIES IN COLOUR

ACT Government

Major Projects Canberra

AECOM

AECOM Australia Pty Ltd

A.B.N. 20 093 846 925

DRAWN C LANE

DESIGNED H CARLYLE

DRG CHECK H ROSSER

DESIGN CHECK S CALLAGHAN

APPROVED J PETERS

HC 10.02.23

SC 10.02.23

JP 10.02.23

HC 16.12.22

SC 16.12.22

JP 16.12.22

CO-ORDINATE SYSTEM: STROMLO

HEIGHT DATUM: AHD

SCALE: AS SHOWN

DESIGN LOT No: S210-STAGE2A

SHEET: 01 OF 13

A1

STATUS: APPROVALS ISSUE

DRG No: S210-ACM-DRW-LAN-NA-2001

EDMS No:

F

NOT FOR CONSTRUCTION

CANBERRA LIGHT RAIL 2A

LANDSCAPE

GENERAL ARRANGEMENT

NORTHBOURNE AVENUE/ ALINGA STREET

SHEET 1

Plot Date & Time: 2/10/2023 7:02 AM

Plotted by CAMERON.LANE1

DF 801*554

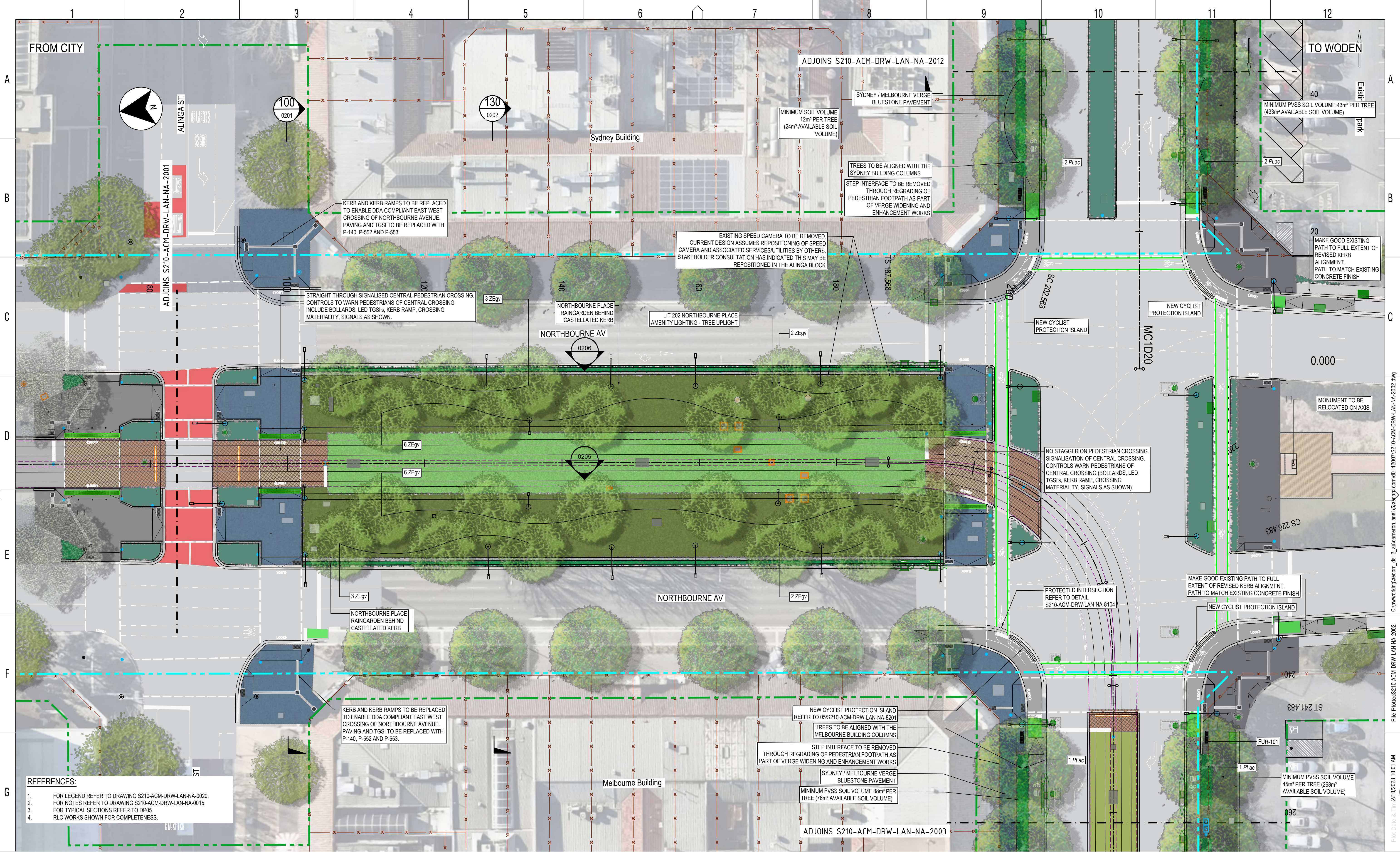

- REFERENCES:
- FOR LEGEND REFER TO DRAWING S210-ACM-DRW-LAN-NA-0020.
 - FOR NOTES REFER TO DRAWING S210-ACM-DRW-LAN-NA-0015.
 - FOR TYPICAL SECTIONS REFER TO DP05.
 - RLC WORKS SHOWN FOR COMPLETENESS.

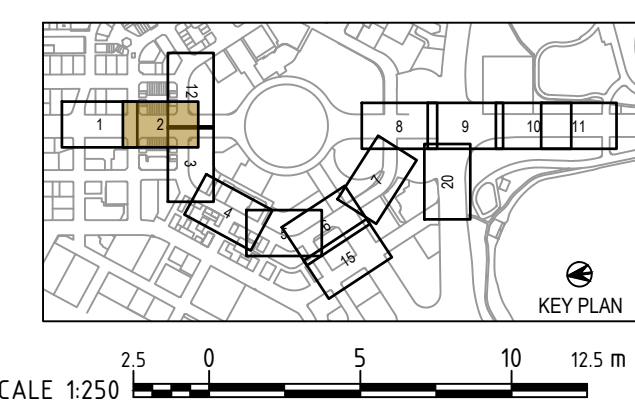

DRAWING COLOUR CODED - PRINT ALL COPIES IN COLOUR

| CO-ORDINATE SYSTEM: | | STROMLO | HEIGHT DATUM: | AHD | SCALE: | AS SHOWN |
|---------------------|--|-----------------|---------------|-------------|-------------|------------|
| DESCRIPTION | | DESIGNER | VERIFIED | APPROVED | SIGN./DATE | SIGN./DATE |
| F | | APPROVALS ISSUE | HC 10.02.23 | SC 10.02.23 | JP 10.02.23 | |
| E | | APPROVALS ISSUE | HC 16.12.22 | SC 16.12.22 | JP 16.12.22 | |
| AMD | | | | | | |

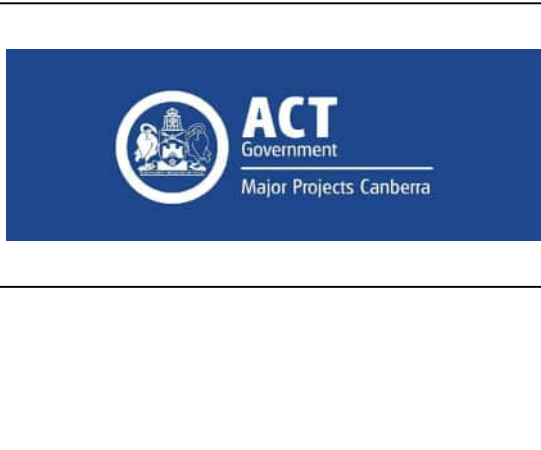

This drawing is confidential and shall only be used for the purpose of this project. The signing of this title block confirms the design and drafting of this project have been prepared and checked in accordance with the Canberra Light Rail Stage 2 quality assurance system to ISO 9001:2015

AECOM
AECOM Australia Pty Ltd
A.B.N. 20 093 846 925

DRAWN: C LANE
DESIGNED: H CARLYLE
DRG CHECK: H ROSSER
DESIGN CHECK: S CALLAGHAN
APPROVED: J PETERS

CANBERRA LIGHT RAIL 2A
LANDSCAPE
GENERAL ARRANGEMENT
CENTRAL CIRCUIT / NORTHBOURNE AVENUE
SHEET 2

DESIGN LOT No: S210-STAGE2A | SHEET: 02 OF 13 | A1
STATUS: APPROVALS ISSUE
DRG No: S210-ACM-DRW-LAN-NA-2002 | EDMS No: | F

NOT FOR CONSTRUCTION

Plot Date & Time: 2/10/2023 10:01 AM
File Path: S210-ACM-DRW-LAN-NA-2002
C:\working\acm\ds12_a\cameron.lane1@actgov.com\01142007\S210-ACM-DRW-LAN-NA-2002.dwg

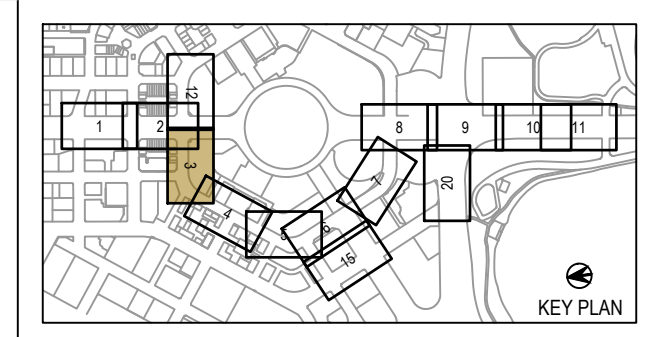
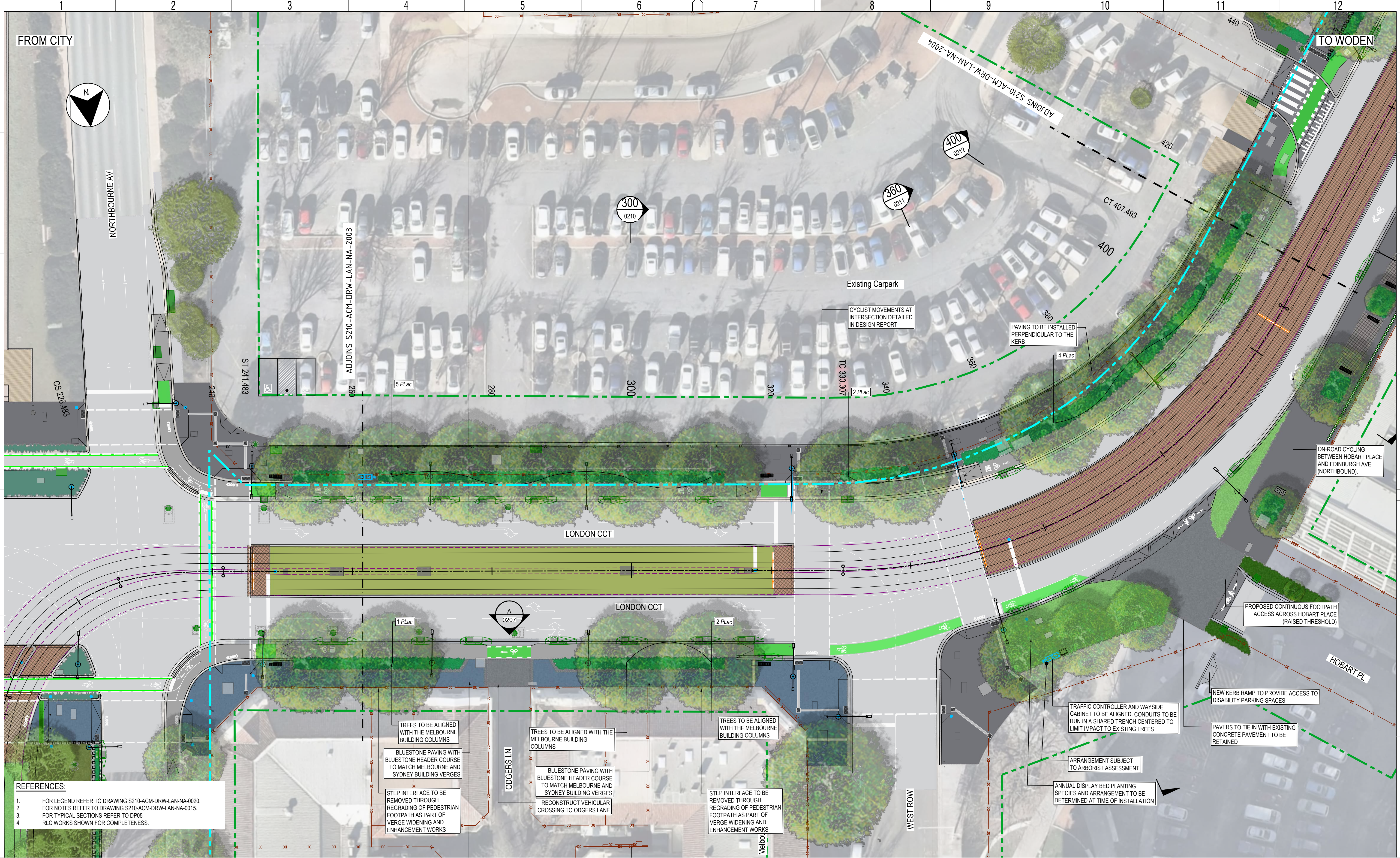

SCALE 1:250
SCALE @ A1

DRAWING COLOUR CODED - PRINT ALL COPIES IN COLOUR

| NO. | DESCRIPTION | DESIGNER SIGN./DATE | VERIFIED SIGN./DATE | APPROVED SIGN./DATE |
|-----|-----------------|---------------------|---------------------|---------------------|
| F | APPROVALS ISSUE | HC 10.02.23 | SC 10.02.23 | JP 10.02.23 |
| E | APPROVALS ISSUE | HC 16.12.22 | SC 16.12.22 | JP 16.12.22 |
| AMD | | | | |

| | | | | | |
|---------------------|---------|---------------|-----|--------|----------|
| CO-ORDINATE SYSTEM: | STROMLO | HEIGHT DATUM: | AHD | SCALE: | AS SHOWN |
|---------------------|---------|---------------|-----|--------|----------|

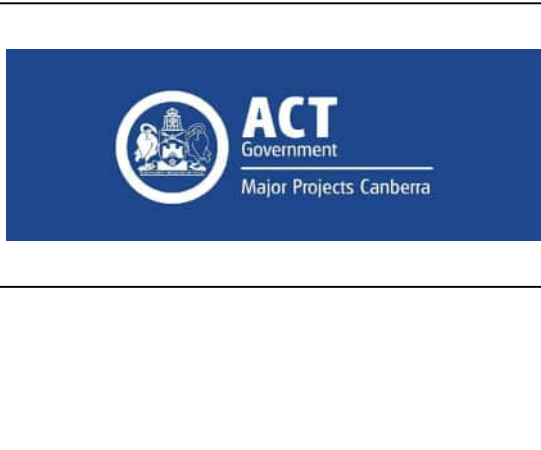

This drawing is confidential and shall only be used for the purpose of this project. The signing of this title block confirms the design and drafting of this project have been prepared and checked in accordance with the Canberra Light Rail Stage 2 quality assurance system to ISO 9001:2015

AECOM
AECOM Australia Pty Ltd
A.B.N. 20 093 846 925

DRAWN: C LANE
DESIGNED: H CARLYLE
DRG CHECK: H ROSSER
DESIGN CHECK: S CALLAGHAN
APPROVED: J PETERS

NOT FOR CONSTRUCTION

CANBERRA LIGHT RAIL 2A
LANDSCAPE
GENERAL ARRANGEMENT
LONDON CIRCUIT / WEST ROW
SHEET 3

DESIGN LOT No: S210-STAGE2A | SHEET: 03 OF 13 | A1
STATUS: APPROVALS ISSUE
DRG No: S210-ACM-DRW-LAN-NA-2003 | EDMS No: F

Plotted by CAMERON LANET

Plot Date & Time: 2/10/2023 7:04 AM
File Path: S210-ACM-DRW-LAN-NA-2003
C:\working\acm\..._s12_au\cameron.lanet\@acm\com\01142007\S210-ACM-DRW-LAN-NA-2003.dwg

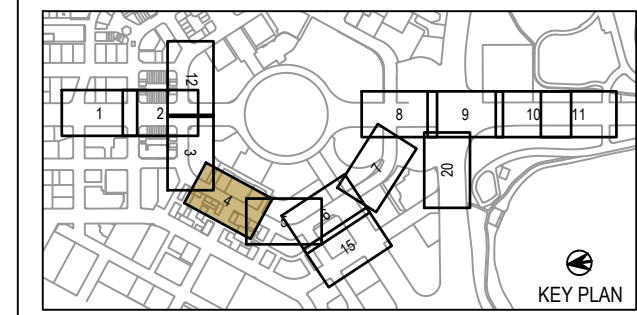
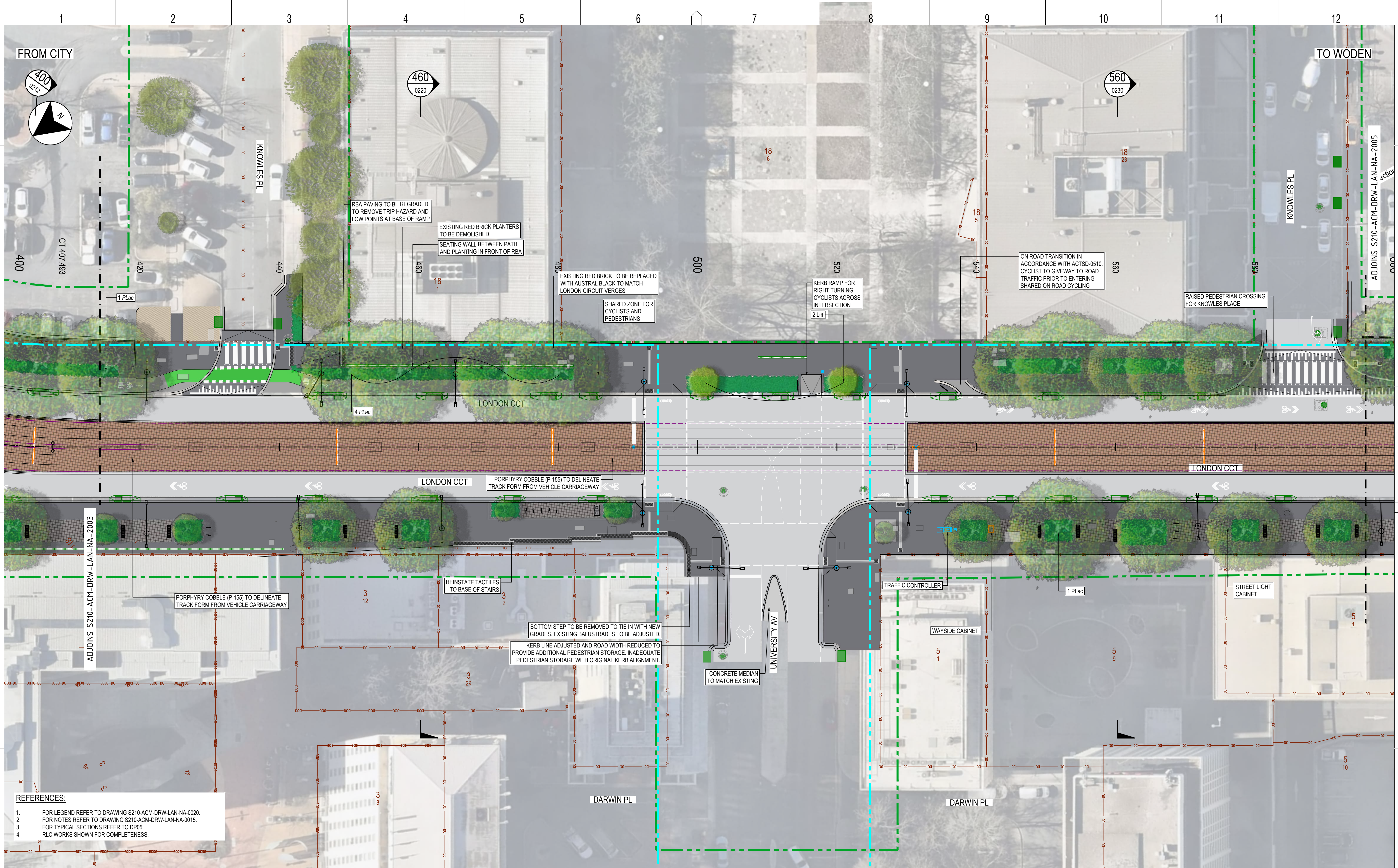

SCALE 1:250
SCALE @ A1

DRAWING COLOUR CODED - PRINT ALL COPIES IN COLOUR

| CO-ORDINATE SYSTEM: | STROMLO | HEIGHT DATUM: | AHD | SCALE: | AS SHOWN |
|---------------------|---------|---------------------|---------------------|---------------------|----------|
| APPROVALS ISSUE | F | HC 10.02.23 | SC 10.02.23 | JP 10.02.23 | |
| APPROVALS ISSUE | E | HC 16.12.22 | SC 16.12.22 | JP 16.12.22 | |
| DESCRIPTION | AMD | DESIGNER SIGN./DATE | VERIFIED SIGN./DATE | APPROVED SIGN./DATE | |



This drawing is confidential and shall only be used for the purpose of this project. The signing of this title block confirms the design and drafting of this project have been prepared and checked in accordance with the Canberra Light Rail Stage 2 quality assurance system to ISO 9001:2015

AECOM
AECOM Australia Pty Ltd
A.B.N. 20 093 846 925

DRAWN C LANE
DESIGNED H CARLYLE
DRG CHECK H ROSSER
DESIGN CHECK S CALLAGHAN
APPROVED J PETERS

NOT FOR CONSTRUCTION

CANBERRA LIGHT RAIL 2A

LANDSCAPE

GENERAL ARRANGEMENT

LONDON CIRCUIT / UNIVERSITY AVENUE

SHEET 4

DESIGN LOT No: S210-STAGE2A

SHEET: 04 OF 13

A1

STATUS: APPROVALS ISSUE

DRG No. S210-ACM-DRW-LAN-NA-2004

EDMS No.

F

Plotted by CAMERON.LANE1

DF 801*554

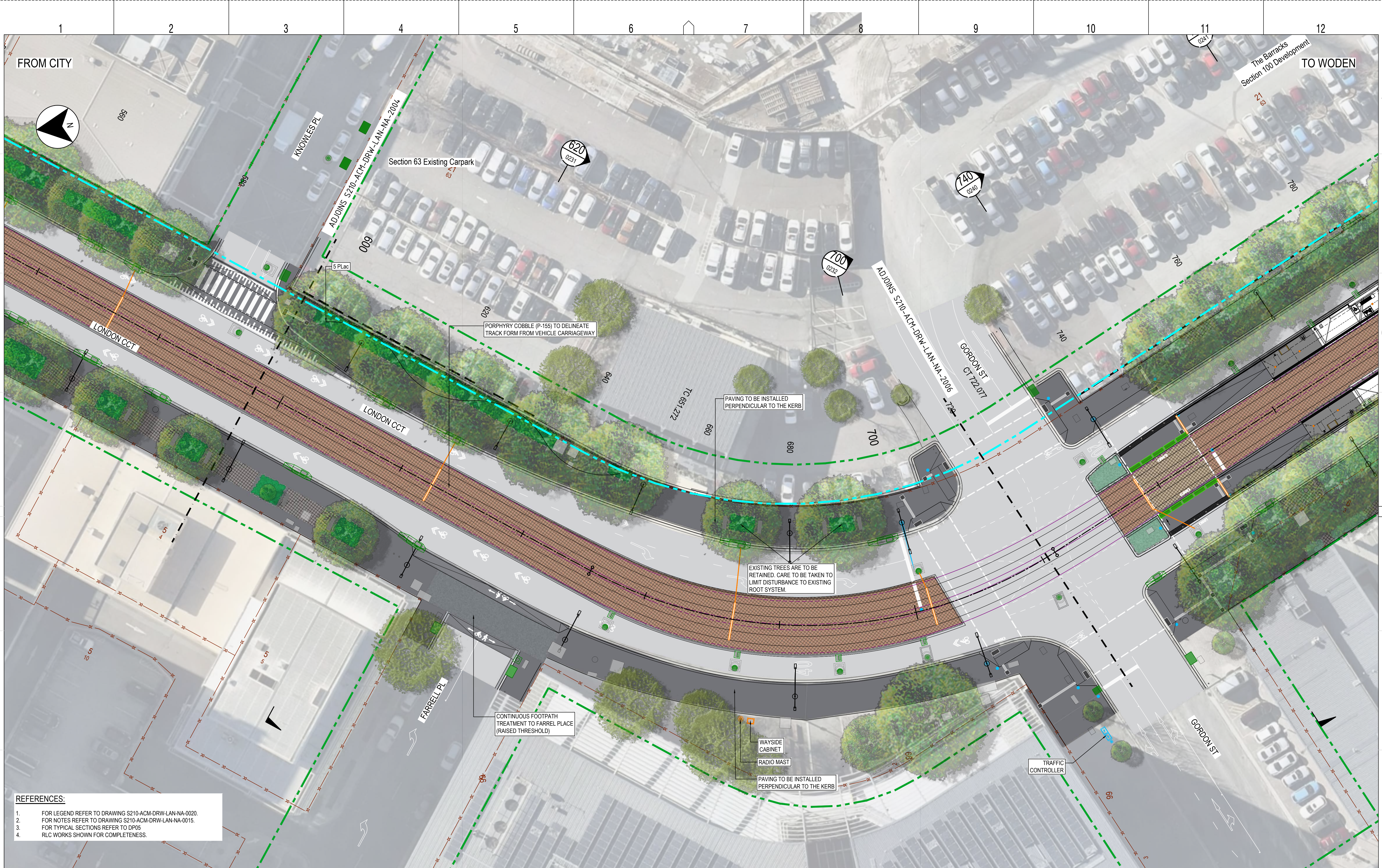

- REFERENCES:
1. FOR LEGEND REFER TO DRAWING S210-ACM-DRW-LAN-NA-0020.
 2. FOR NOTES REFER TO DRAWING S210-ACM-DRW-LAN-NA-0015.
 3. FOR TYPICAL SECTIONS REFER TO DP05
 4. RLC WORKS SHOWN FOR COMPLETENESS.

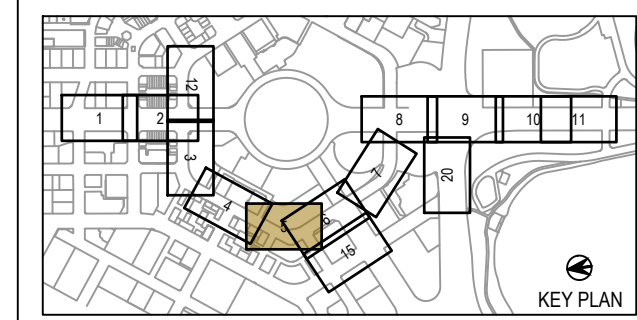

SCALE 1:250
SCALE @ A1

DRAWING COLOUR CODED - PRINT ALL COPIES IN COLOUR

| | | | | |
|-----------------------------|-----------------|------------------------|------------------------|------------------------|
| F | APPROVALS ISSUE | HC 10.02.23 | SC 10.02.23 | JP 10.02.23 |
| E | APPROVALS ISSUE | HC 16.12.22 | SC 16.12.22 | JP 16.12.22 |
| AMD | DESCRIPTION | DESIGNER SIGN./DATE | VERIFIED SIGN./DATE | APPROVED SIGN./DATE |
| CO-ORDINATE SYSTEM: STROMLO | | HEIGHT DATUM: AHD | SCALE: AS SHOWN | |



This drawing is confidential and shall only be used for the purpose of this project.
The signing of this title block confirms the design and drafting of this project have been prepared and checked in accordance with the Canberra Light Rail Stage 2 quality assurance system to ISO 9001:2015

AECOM
AECOM Australia Pty Ltd
A.B.N. 20 093 846 925

DRAWN C LANE
DESIGNED H CARLYLE
DRG CHECK H ROSSER
DESIGN CHECK S CALLAGHAN
APPROVED J PETERS

CANBERRA LIGHT RAIL 2A
LANDSCAPE
GENERAL ARRANGEMENT
LONDON CIRCUIT / GORDON STREET
SHEET 5

DESIGN LOT No: S210-STAGE2A | SHEET: 05 OF 13 | A1
STATUS: APPROVALS ISSUE
DRG No: S210-ACM-DRW-LAN-NA-2005 | EDMS No: F

C:\working\acrom\12_au\canberra\lane1\@baker\com\01142007\S210-ACM-DRW-LAN-NA-2005.dwg
File Plotted: S210-ACM-DRW-LAN-NA-2005
Plot Date & Time: 2/10/2023 10:03 AM

Plotted by CAMERON.LANE1

DF 801*554

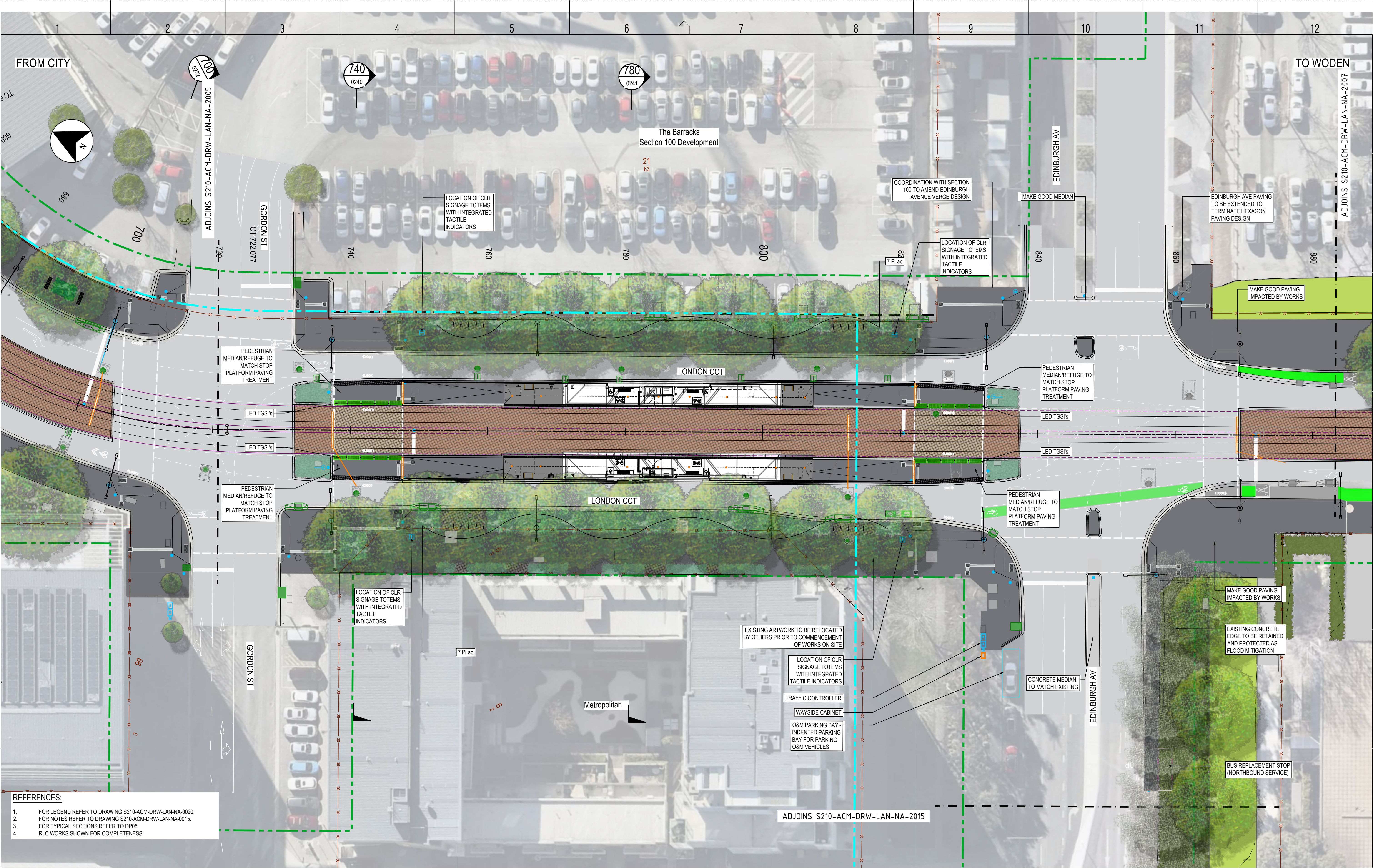

REFERENCES:

- FOR LEGEND REFER TO DRAWING S210-ACM-DRW-LAN-NA-0020.
- FOR NOTES REFER TO DRAWING S210-ACM-DRW-LAN-NA-0015.
- FOR TYPICAL SECTIONS REFER TO DP05.
- RLC WORKS SHOWN FOR COMPLETENESS.



SCALE 1:250
SCALE @ A1

DRAWING COLOUR CODED - PRINT ALL COPIES IN COLOUR

| | | | | | |
|-----------------------------|-----------------|------------------------|------------------------|------------------------|--|
| | | | | | |
| F | APPROVALS ISSUE | HC 10.02.23 | SC 10.02.23 | JP 10.02.23 | |
| E | APPROVALS ISSUE | HC 16.12.22 | SC 16.12.22 | JP 16.12.22 | |
| AMD | DESCRIPTION | DESIGNER SIGN./DATE | VERIFIED SIGN./DATE | APPROVED SIGN./DATE | |
| CO-ORDINATE SYSTEM: STROMLO | | HEIGHT DATUM: AHD | | SCALE: AS SHOWN | |



This drawing is confidential and shall only be used for the purpose of this project. The signing of this title block confirms the design and drafting of this project have been prepared and checked in accordance with the Canberra Light Rail Stage 2 quality assurance system to ISO 9001:2015



DRAWN C LANE
DESIGNED H CARLYLE
DRG CHECK H ROSSER
DESIGN CHECK S CALLAGHAN
APPROVED J PETERS

CANBERRA LIGHT RAIL 2A
LANDSCAPE
GENERAL ARRANGEMENT
LONDON CIRCUIT / EDINBURGH AVENUE
SHEET 6

DESIGN LOT No: S210-STAGE2A | SHEET: 06 OF 13 | A1
STATUS: APPROVALS ISSUE
DRG No: S210-ACM-DRW-LAN-NA-2006 | EDMS No: F

Plot Date & Time: 2/10/2023 10:09 AM
File: PlottedS210-ACM-DRW-LAN-NA-2006
C:\working\acm\..._ds12_au\cameron.lane1@actgov.com\01142007\S210-ACM-DRW-LAN-NA-2006.dwg

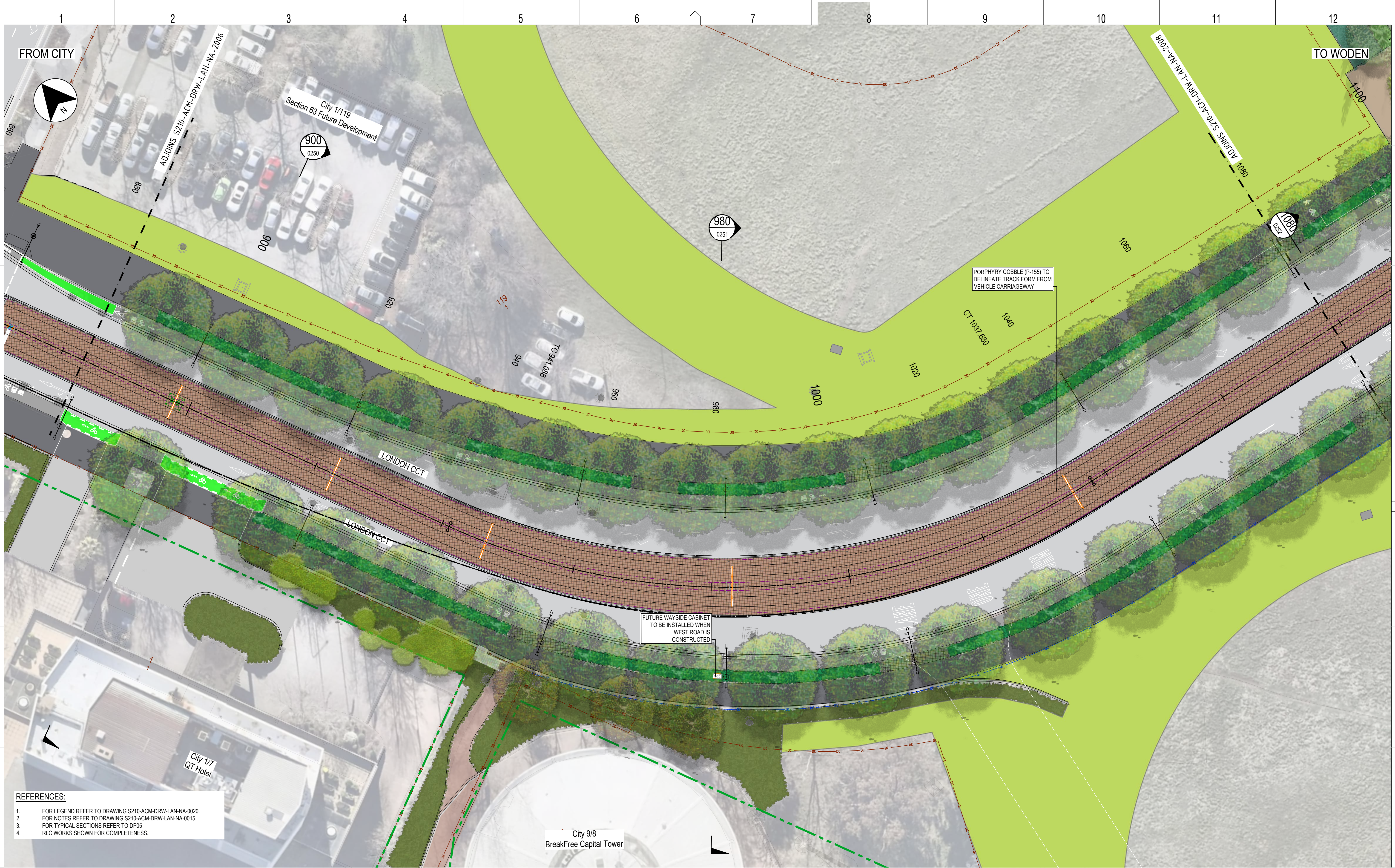

- REFERENCES:
1. FOR LEGEND REFER TO DRAWING S210-ACM-DRW-LAN-NA-0020.
 2. FOR NOTES REFER TO DRAWING S210-ACM-DRW-LAN-NA-0015.
 3. FOR TYPICAL SECTIONS REFER TO DP05
 4. RLC WORKS SHOWN FOR COMPLETENESS.

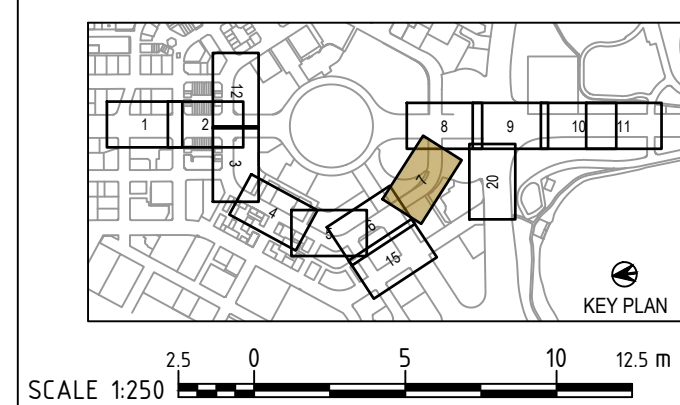

DRAWING COLOUR CODED - PRINT ALL COPIES IN COLOUR

| | | | | |
|-----------------------------|-----------------|---------------------|---------------------|---------------------|
| F | APPROVALS ISSUE | HC 10.02.23 | SC 10.02.23 | JP 10.02.23 |
| E | APPROVALS ISSUE | HC 16.12.22 | SC 16.12.22 | JP 16.12.22 |
| AMD | DESCRIPTION | DESIGNER SIGN./DATE | VERIFIED SIGN./DATE | APPROVED SIGN./DATE |
| CO-ORDINATE SYSTEM: STROMLO | | HEIGHT DATUM: AHD | SCALE: AS SHOWN | |



This drawing is confidential and shall only be used for the purpose of this project. The signing of this title block confirms the design and drafting of this project have been prepared and checked in accordance with the Canberra Light Rail Stage 2 quality assurance system to ISO 9001:2015

AECOM
AECOM Australia Pty Ltd
A.B.N. 20 093 846 925

DRAWN C LANE
DESIGNED H CARLYLE
DRG CHECK H ROSSER
DESIGN CHECK S CALLAGHAN
APPROVED J PETERS

NOT FOR CONSTRUCTION

CANBERRA LIGHT RAIL 2A
LANDSCAPE
GENERAL ARRANGEMENT
COMMONWEALTH AVENUE / LONDON CIRCUIT
SHEET 7

DESIGN LOT No: S210-STAGE2A | SHEET: 07 OF 13 | A1
STATUS: APPROVALS ISSUE
DRG No: S210-ACM-DRW-LAN-NA-2007 | EDMS No: F

C:\pwworking\aecom\cs12_au\canberran_lane1\0142007\S210-ACM-DRW-LAN-NA-2007.dwg
Plot Date & Time: 2/9/2023 9:06 PM
Plotted by CAMERON.LANE1
DF 801554

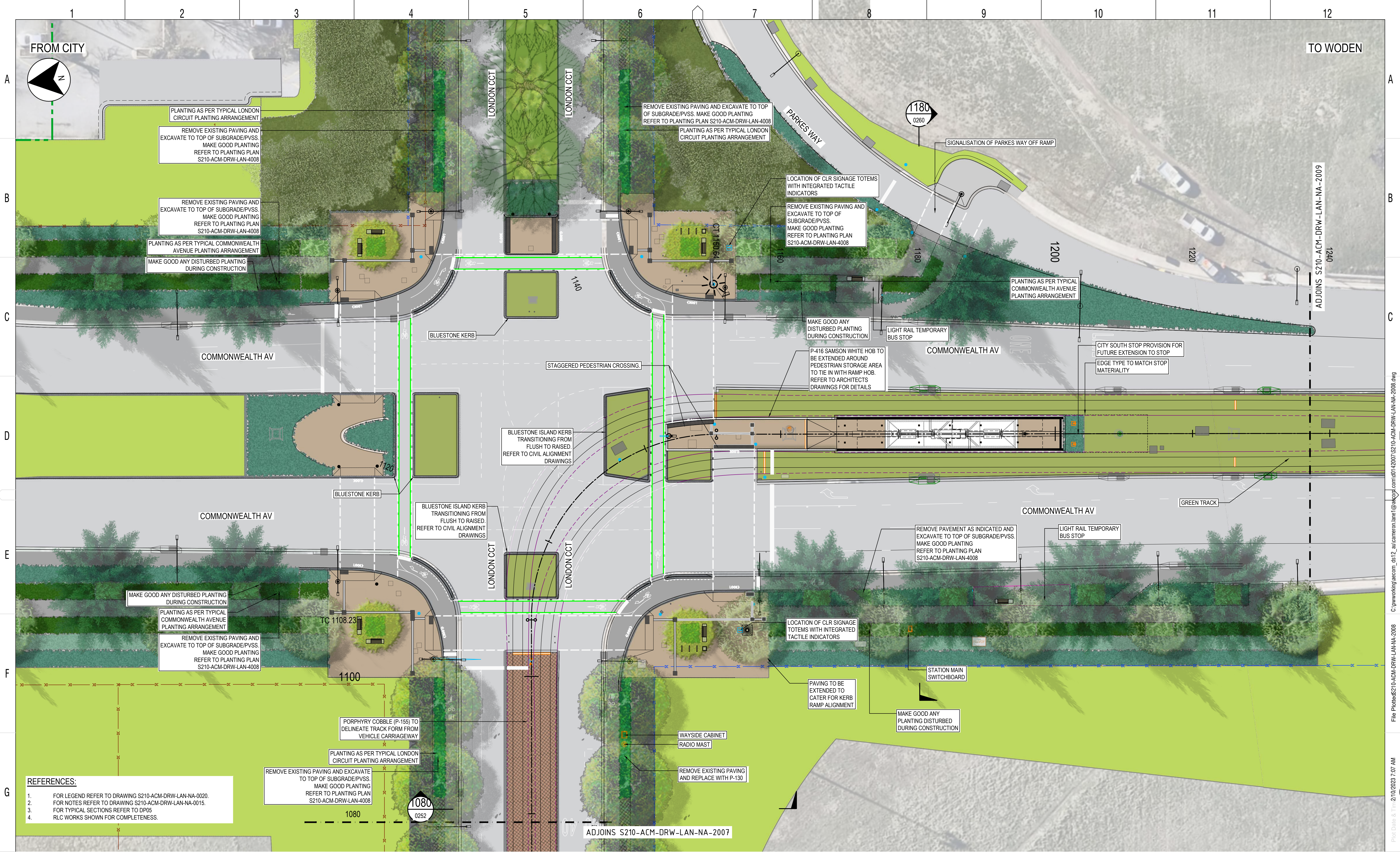

KEY PLAN

SCALE 1:250
SCALE @ A1

DRAWING COLOUR CODED - PRINT ALL COPIES IN COLOUR

| | | | | |
|-----------------------------|-----------------|------------------------|------------------------|------------------------|
| F | APPROVALS ISSUE | HC 10.02.23 | SC 10.02.23 | JP 10.02.23 |
| E | APPROVALS ISSUE | HC 16.12.22 | SC 16.12.22 | JP 16.12.22 |
| AMD | DESCRIPTION | DESIGNER SIGN./DATE | VERIFIED SIGN./DATE | APPROVED SIGN./DATE |
| CO-ORDINATE SYSTEM: STROMLO | | HEIGHT DATUM: AHD | | SCALE: AS SHOWN |

ACT
Government
Major Projects Canberra

This drawing is confidential and shall only be used for the purpose of this project.
The signing of this title block confirms the design and drafting of this project have been prepared and checked in accordance with the Canberra Light Rail Stage 2 quality assurance system to ISO 9001:2015

AECOM
AECOM Australia Pty Ltd
A.B.N. 20 093 846 925

| | |
|--------------|-------------|
| DRAWN | C LANE |
| DESIGNED | H CARLYLE |
| DRG CHECK | H ROSSER |
| DESIGN CHECK | S CALLAGHAN |
| APPROVED | J PETERS |

CANBERRA LIGHT RAIL 2A
LANDSCAPE
GENERAL ARRANGEMENT
COMMONWEALTH AV/CITY SOUTH STOP
SHEET 8

DESIGN LOT No: S210-STAGE2A | SHEET: 08 OF 13 | A1

STATUS: APPROVALS ISSUE

DRG No: S210-ACM-DRW-LAN-NA-2008 | EDMS No.

Plotted by CAMERON LANE1

DF 801*554

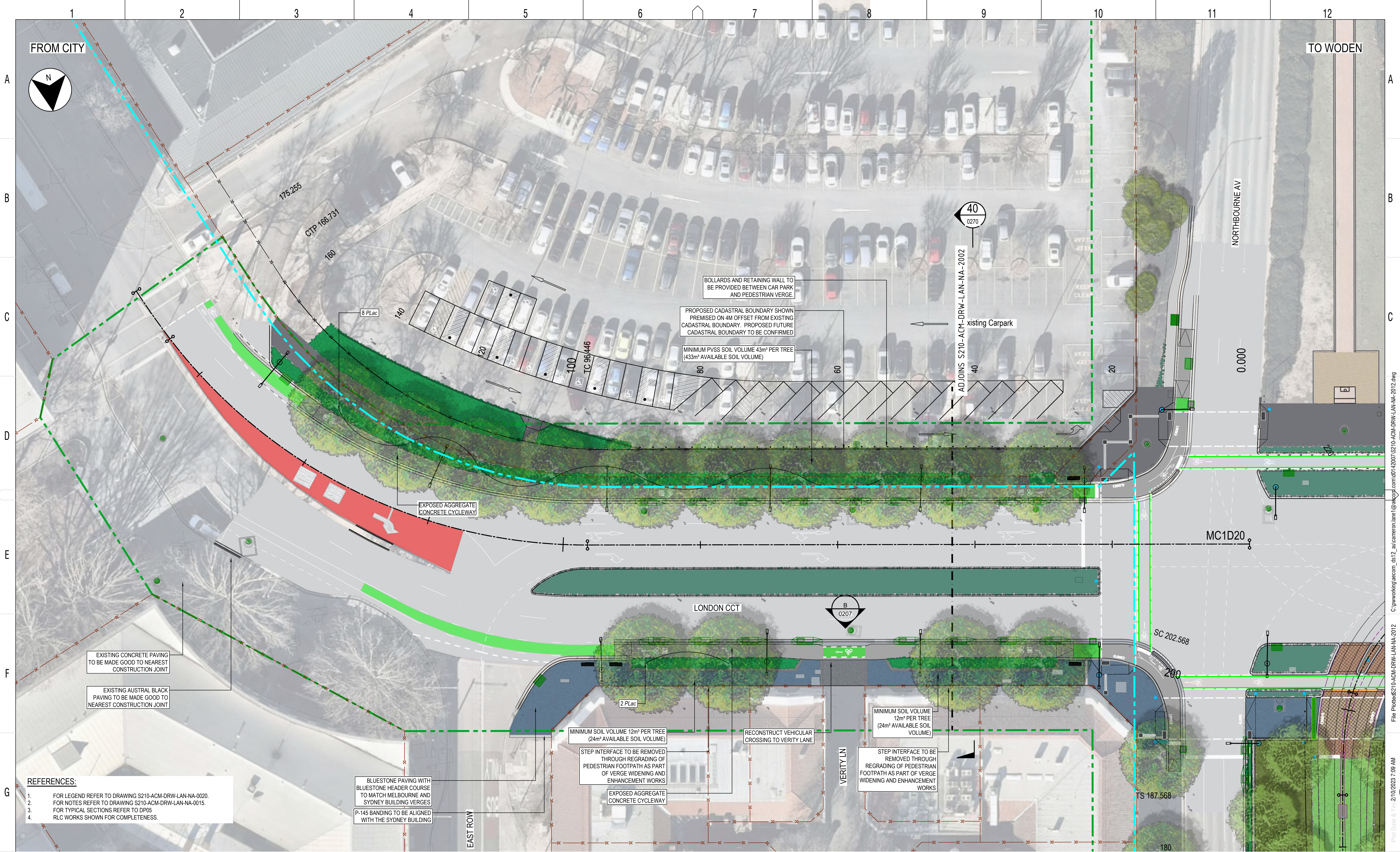

REFERENCES:
1. FOR LEGEND REFER TO DRAWING S210-ACM-DRW-LAN-NA-0020.
2. FOR NOTES REFER TO DRAWING S210-ACM-DRW-LAN-NA-0015.
3. FOR TYPICAL SECTIONS REFER TO DP05
4. RLC WORKS SHOWN FOR COMPLETENESS.

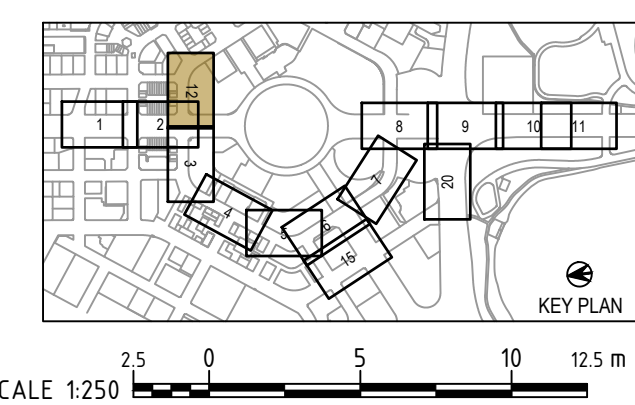

DRAWING COLOUR CODED - PRINT ALL COPIES IN COLOUR

| | | | | |
|-----------------------------|-----------------|------------------------|------------------------|------------------------|
| F | APPROVALS ISSUE | HC 10.02.23 | SC 10.02.23 | JP 10.02.23 |
| E | APPROVALS ISSUE | HC 16.12.22 | SC 16.12.22 | JP 16.12.22 |
| AMD | DESCRIPTION | DESIGNER SIGN./DATE | VERIFIED SIGN./DATE | APPROVED SIGN./DATE |
| CO-ORDINATE SYSTEM: STROMLO | | HEIGHT DATUM: AHD | SCALE: AS SHOWN | |



This drawing is confidential and shall only be used for the purpose of this project.
The signing of this title block confirms the design and drafting of this project have been prepared and checked in accordance with the Canberra Light Rail Stage 2 quality assurance system to ISO 9001:2015

AECOM
AECOM Australia Pty Ltd
A.B.N. 20 093 846 925

DRAWN C LANE
DESIGNED H CARLYLE
DRG CHECK H ROSSER
DESIGN CHECK S CALLAGHAN
APPROVED J PETERS

CANBERRA LIGHT RAIL 2A
LANDSCAPE
GENERAL ARRANGEMENT
LONDON CIRCUIT / NORTHBOURNE AVENUE
SHEET 12

DESIGN LOT No: S210-STAGE2A | SHEET: 12 OF 13 | A1
STATUS: APPROVALS ISSUE
DRG No: S210-ACM-DRW-LAN-NA-2012 | EDMS No: F

NOT FOR CONSTRUCTION

Plot Date & Time: 2/10/2023 7:09 AM
File Path: S210-ACM-DRW-LAN-NA-2012
C:\working\acm\ds12_aucameron.lanet@actgovt.com\01142007\S210-ACM-DRW-LAN-NA-2012.dwg



H

KEY PLAN

SCALE 1:250
SCALE @ A1

DRAWING COLOUR CODED - PRINT ALL COPIES IN COLOUR

| | | | | |
|-----------------------------|--------------------------------------|------------------------|------------------------|------------------------|
| C | APPROVALS ISSUE | HC 10.02.23 | SC 10.02.23 | JP 10.02.23 |
| B | APPROVALS ISSUE | HC 16.12.22 | SC 16.12.22 | JP 16.12.22 |
| A | CO-ORDINATION SET - WORK IN PROGRESS | HC 04.11.22 | SC 04.11.22 | JP 04.11.22 |
| AMD | DESCRIPTION | DESIGNER SIGN./DATE | VERIFIED SIGN./DATE | APPROVED SIGN./DATE |
| CO-ORDINATE SYSTEM: STROMLO | | HEIGHT DATUM: AHD | SCALE: AS SHOWN | |

ACT
Government
Major Projects Canberra

AECOM
AECOM Australia Pty Ltd
A.B.N. 20 093 846 925

This drawing is confidential and shall only be used for the purpose of this project.
The signing of this title block confirms the design and drafting of this project have been prepared and checked in accordance with the Canberra Light Rail Stage 2 quality assurance system to ISO 9001:2015

DRAWN C LANE
DESIGNED H CARLYLE
DRG CHECK H ROSSER
DESIGN CHECK S CALLAGHAN
APPROVED J PETERS

CANBERRA LIGHT RAIL 2A
LANDSCAPE
GENERAL ARRANGEMENT
EDINBURGH AV / GORDON ST
SHEET 15

DESIGN LOT No: S210-STAGE2A | SHEET: 13 OF 13 | A1
STATUS: APPROVALS ISSUE
DRG No. S210-ACM-DRW-LAN-NA-2015 | EDMS No. C

NOT FOR CONSTRUCTION

Plot Date & Time: 2/10/2023 7:11 AM
Plotted by CAMERON.LANE1

DF 801*554