

DEMOLITION NOTES

A PROPOSED METHOD-DISMANTLE ROOF, TIMBER TRUSSES AND TIMBER BEAMS FOR SALVAGE AND RE USE. REMOVAL OF ALL GLASS AND WINDOWS FOR RE USE. BRICK WALLS TO BE DISMANTLED BY HAND AND SOLD. ANY BROKEN REMAINS TO BE CRUSHED FOR RECYCLING. INTERNAL GYPROCK WALLS AND FRAMES TO BE DISMANTLED BY HAND AND TAKEN TO TIP. THE REMAINS WOULD THEN BE MADE UP OF CONCRETE SLABS AND VERANDAHS AND CONCRETE DRIVEWAYS AND CARPARKING. THIS WOULD BE DELIVERED TO CANBERRA RECYCLERS AT PIALLAGO FOR RECYCLING. B:POLLUTION- AS PER ABOVE AND A.C.T. POLLUTION CONTROL LAWS. C:ASBESTOS- FIBRO SHEET WHERE ENCOUNTERED WILL BE DISPOSED OF BY BAGGING WITH PROTECTIVE CLOTHING AS PER REGULATION AND DELIVERED AT THE APPROPRIATE AREA OF BELCONNEN TIP. D:EXISTING SERVICES- ELECTRICITY TO BE DISCONNECTED AS PER ACTEW REQUIREMENTS AND RECONNECTED THROUGH TEMPORARY SUPPLY. SEWERAGE AND STORMWATER TO BE CAPPED OFF WHERE REQUIRED. WATER SUPPLY TO BE CAPPED OF WHERE NECESSARY TO ALLOW FOR CONSTRUCTION. TELEPHONE LINE TO BE RELOCATED IF NECESSARY TO TELSTRA REQUIREMENTS.

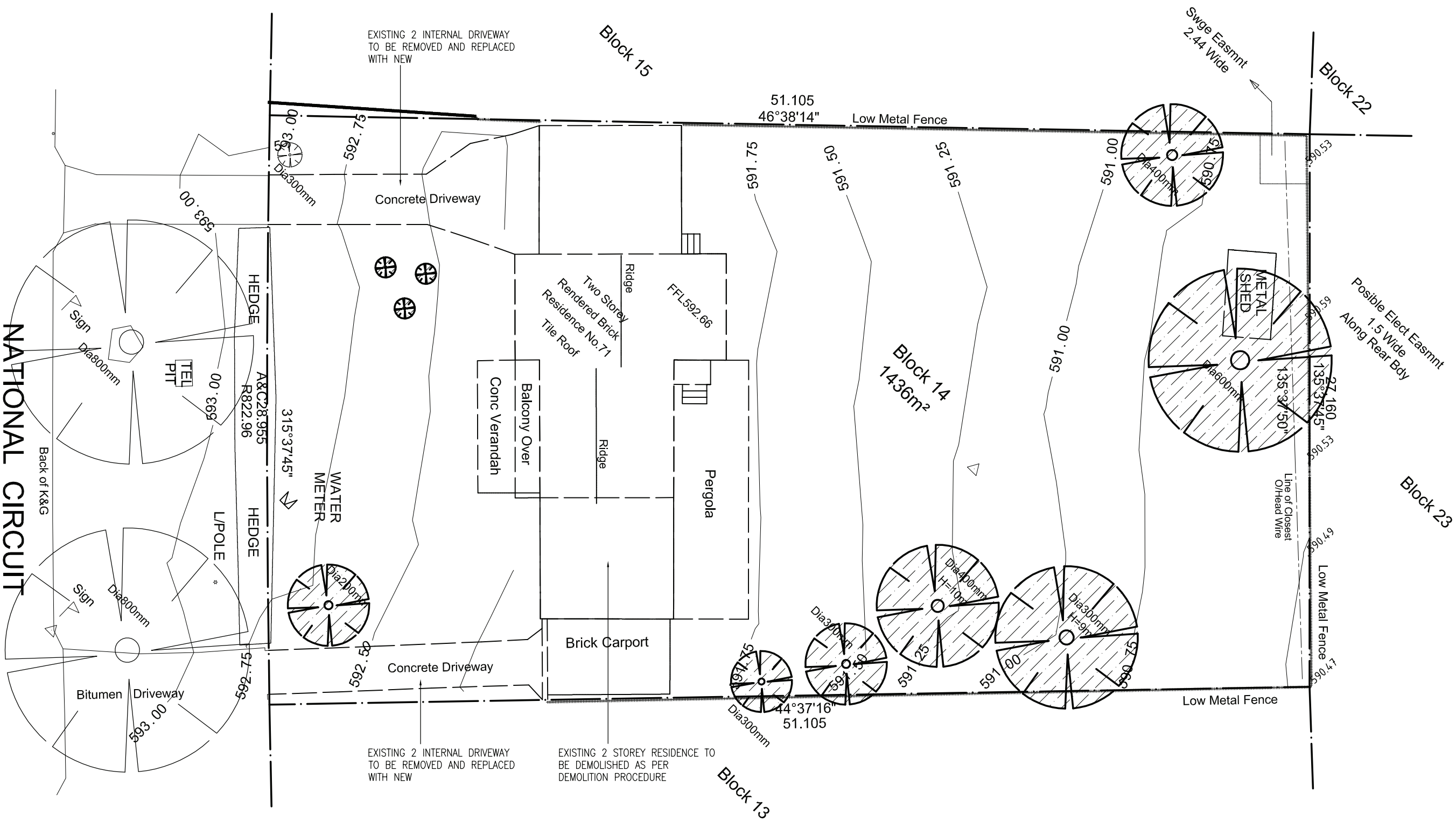

DEMOLITION PLAN  
Scale 1:200 @ A2

	TREES TO BE RETAINED
	NON SIGNIFICANT TREES TO BE REMOVED