

BLOCKS 4 & 5 SECTION 38 CAMPBELL  
SHADOW DIAGRAMS - SUMMER SOLSTICE

Shadow diagrams are provided at half hour intervals from 9.30-10.30am and 2-3pm on the summer and winter solstice (following).

Taller buildings (apartments) are orientated north-south to maximise solar access between buildings to external landscape spaces.

Lower buildings (townhouses) are generally orientated to provide a balance of solar access (to indoor and outdoor spaces), views and privacy.

MORNING

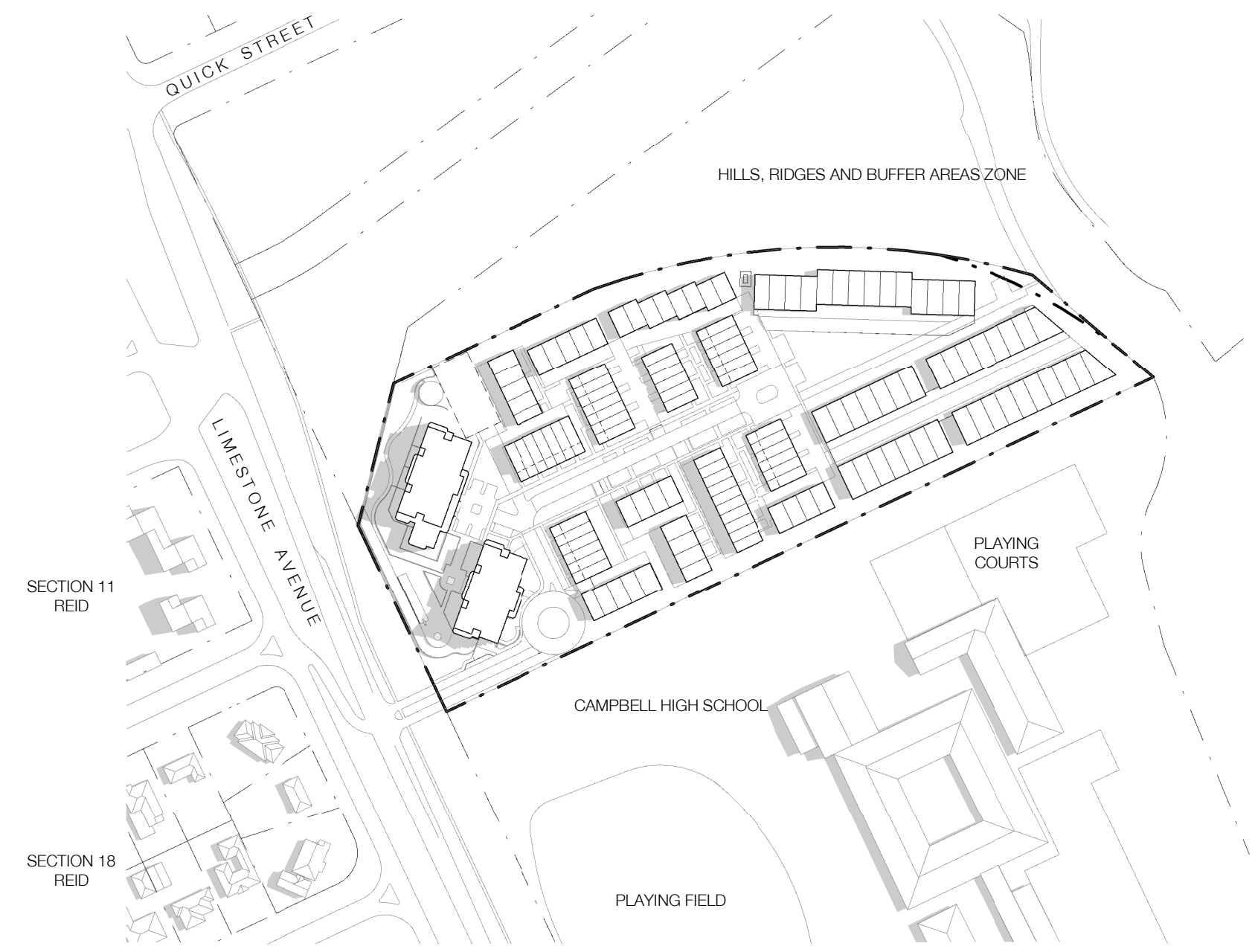

SUMMER SOLSTICE 9.30am

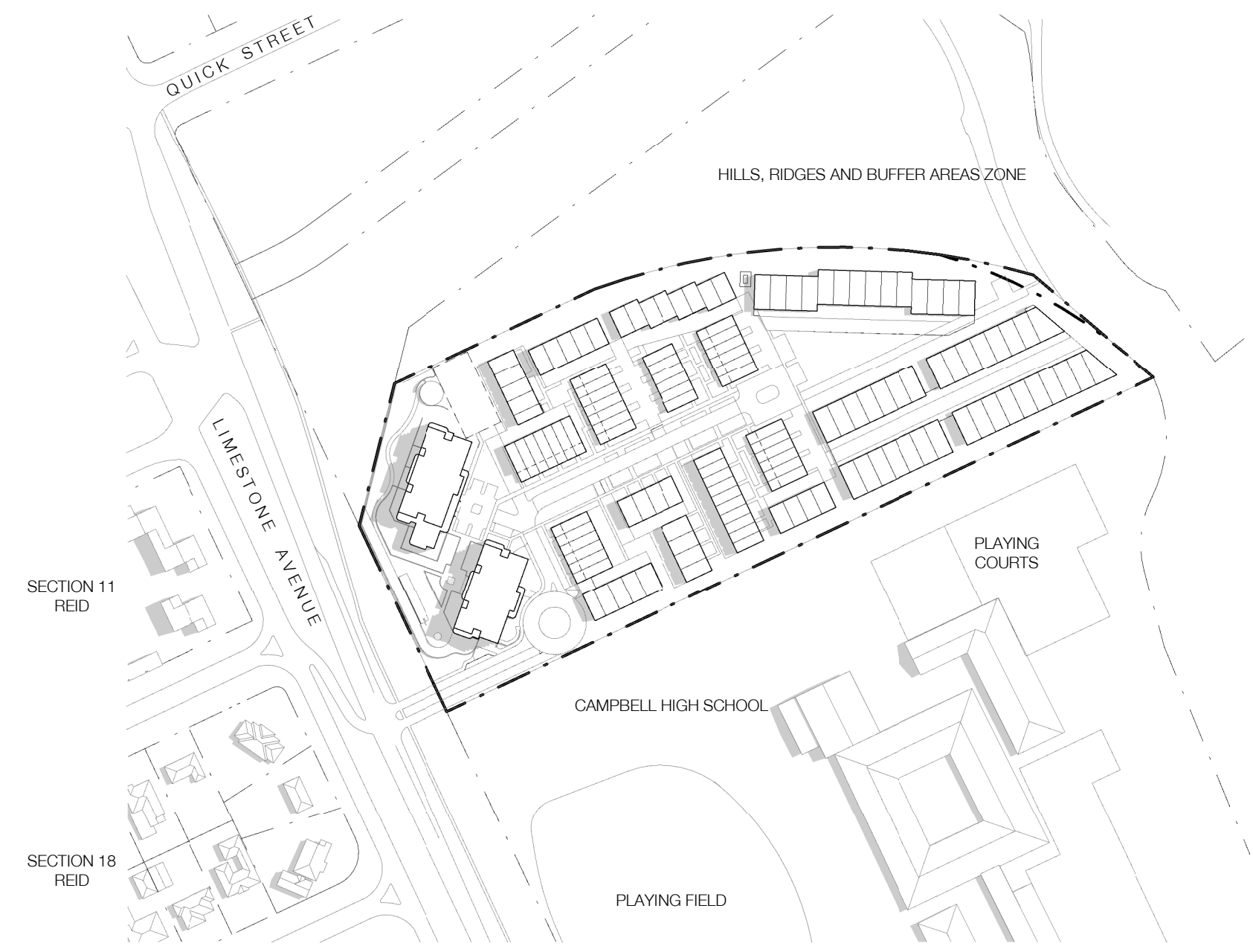

SUMMER SOLSTICE 10.00am

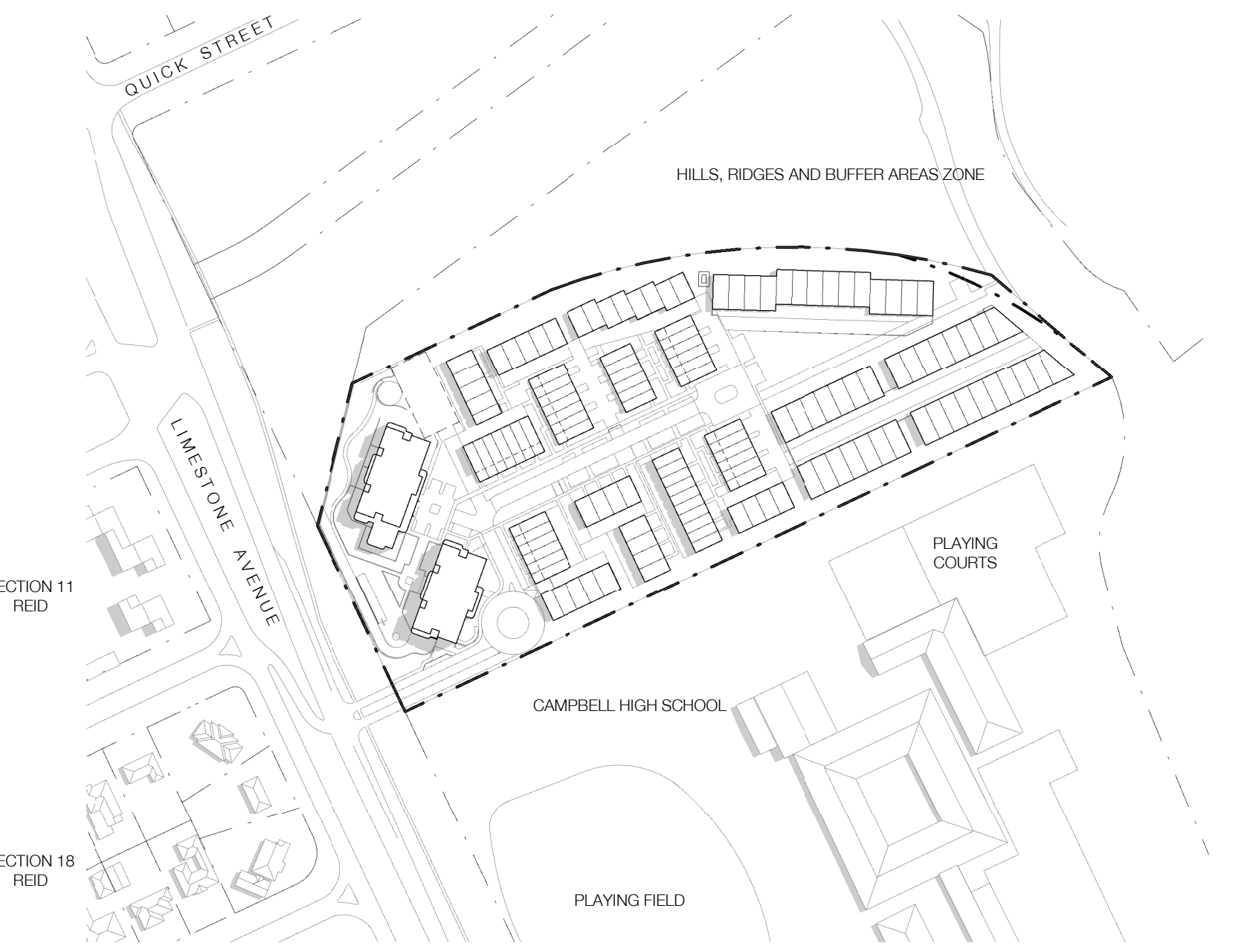

SUMMER SOLSTICE 10.30am

AFTERNOON

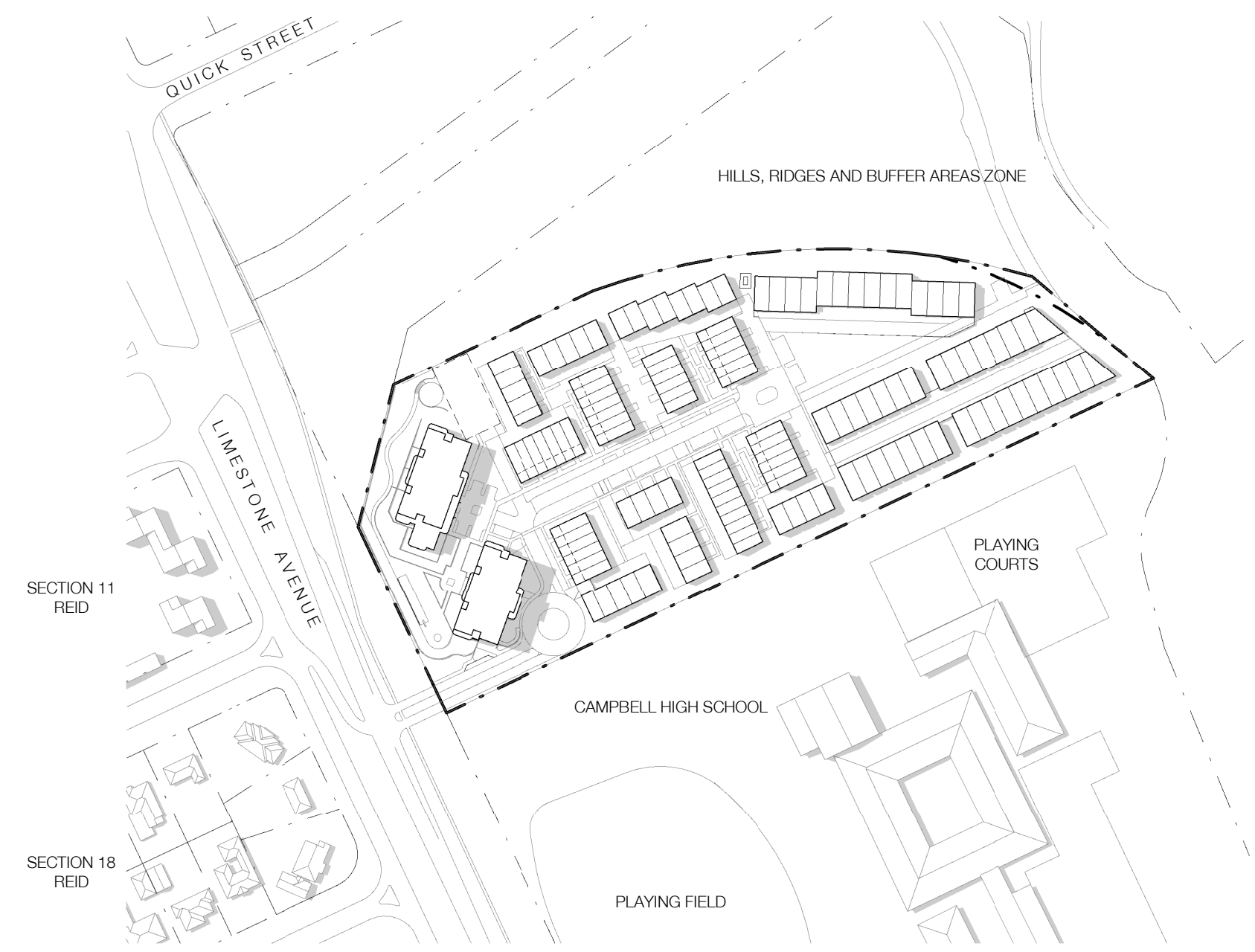

SUMMER SOLSTICE 2.00pm

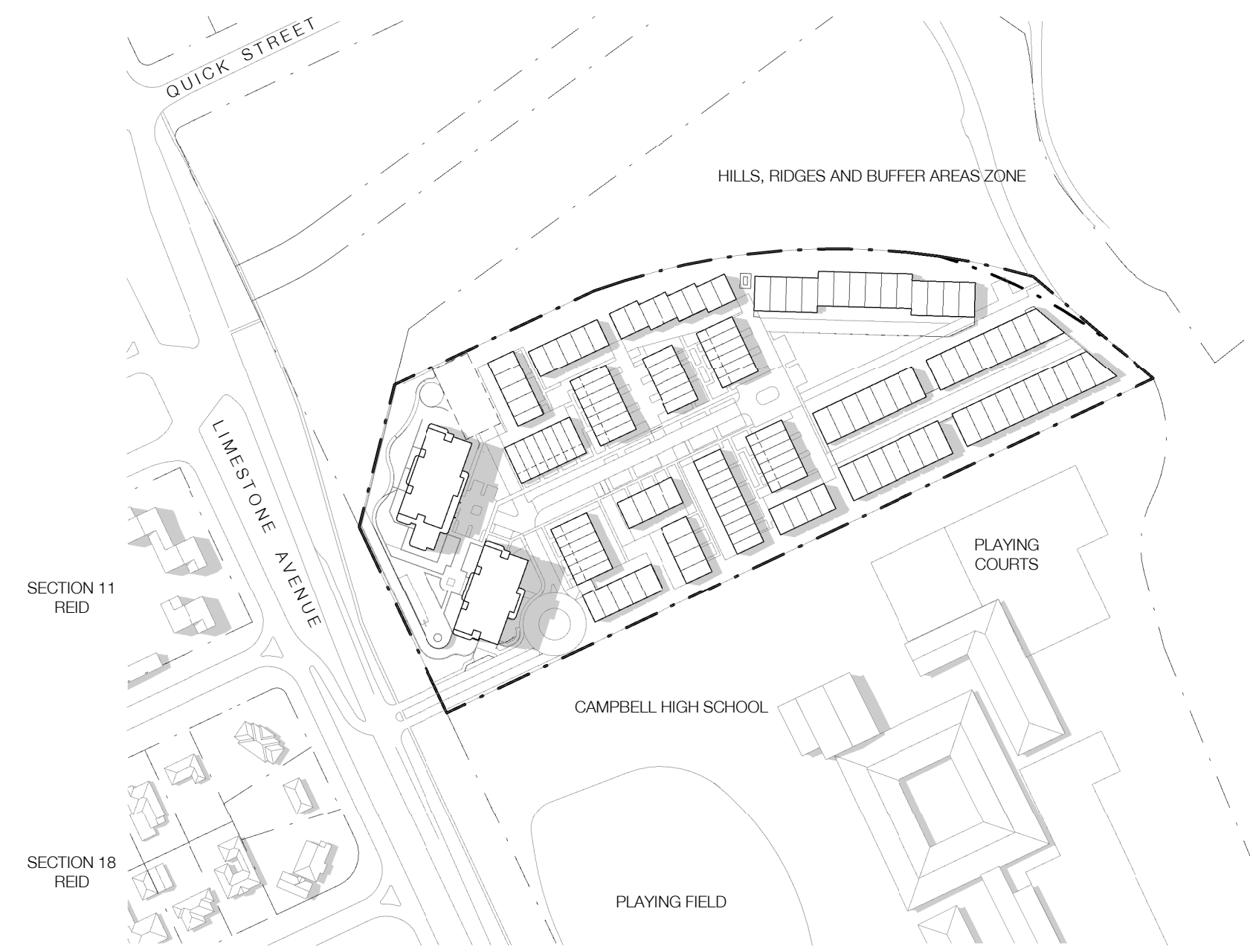

SUMMER SOLSTICE 2.30pm

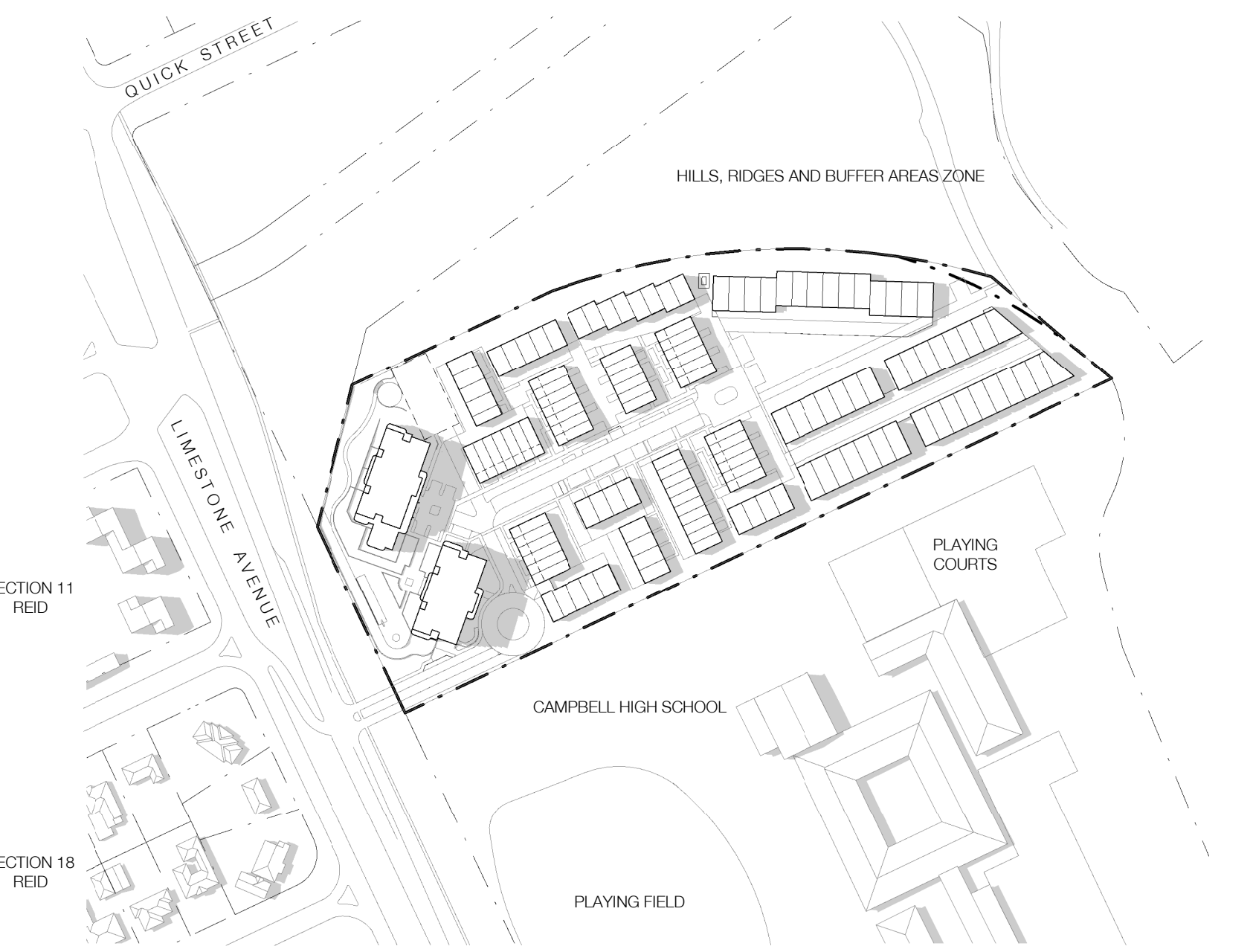

SUMMER SOLSTICE 3.00pm

