

CGS Rowing Shed Redevelopment

Canberra Grammar School

LANDSCAPE DOCUMENTATION

ISSUE: FOR APPROVAL

DATE: 29/03/2018

SHEET PLAN 1:250

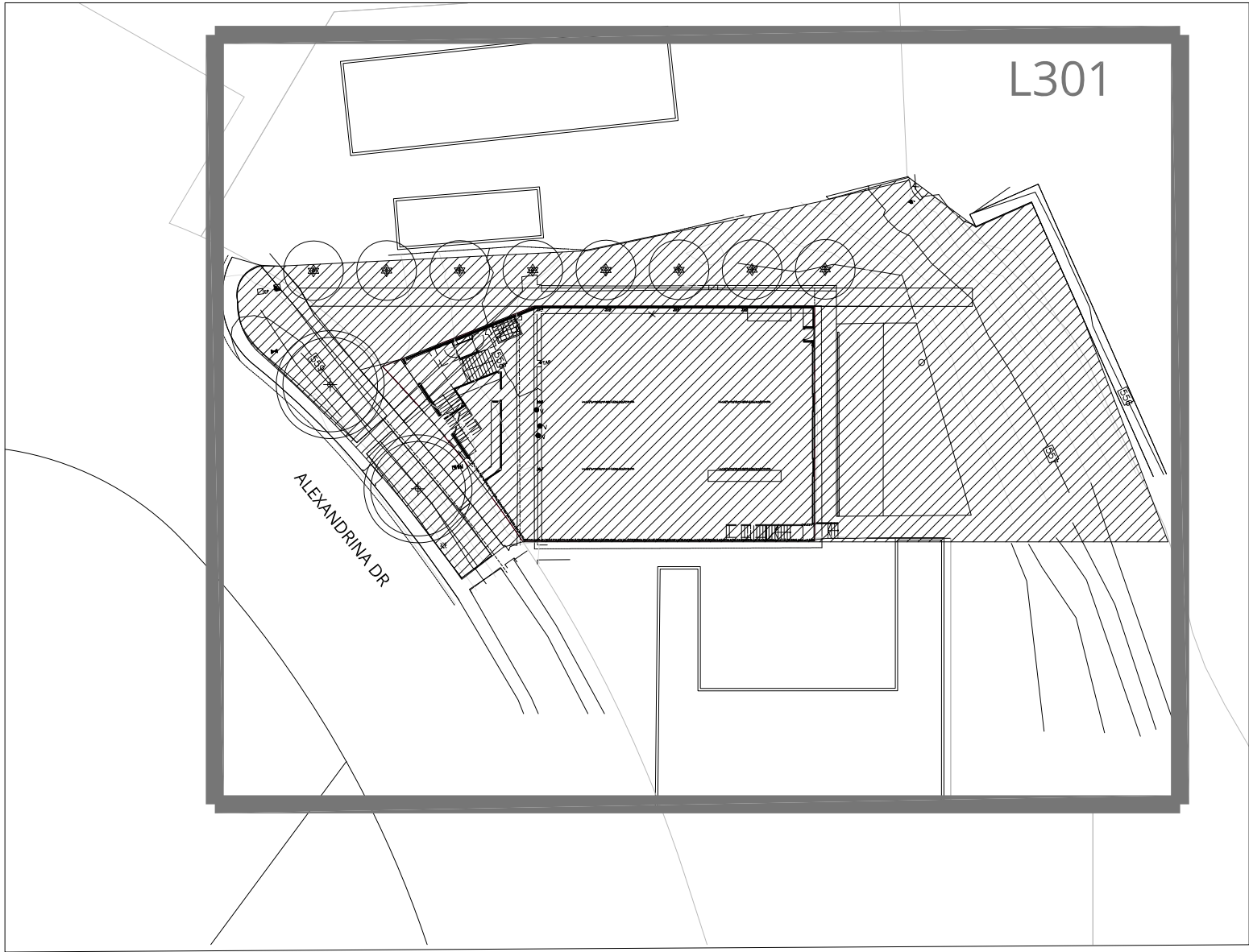

DRAWING SCHEDULE		
DWG No.	DRAWING TITLE	ISSUE
L.000	COVER PAGE	A
L.301	LANDSCAPE PLAN	A
L.801	LANDSCAPE DETAILS 1	A

REVISION	DATE	AMENDMENT	DRAWN	CHECKED	APPROVED
A	29.03.2018	FOR APPROVAL	BC	RS	CL

SCALE A1



© COPYRIGHT
THIS DRAWING REMAINS THE PROPERTY OF CIA LANDSCAPES + COLOUR. IT MAY BE USED FOR THE
PURPOSE FOR WHICH IT WAS COMMISSIONED AND IN ACCORDANCE WITH THE TERMS OF ENGAGEMENT
FOR THAT COMMISSION. REPRODUCTION OF THIS WHOLE OR PART OF THE DOCUMENT CONSTITUTES
AN INFRINGEMENT OF COPYRIGHT. THE INFORMATION, IDEAS AND CONCEPTS CONTAINED IN THIS
DOCUMENT ARE PROHIBITED FROM DISCLOSING SUCH INFORMATION, IDEAS AND CONCEPTS TO ANY
PERSON WITHOUT THE PRIOR WRITTEN CONSENT OF THE COPYRIGHT HOLDER.

Cia
landscapes
+
colour

36 Mildura Street Fyshwick ACT 2609
Po Box 75 Red Hill
ACT 2603

cialandscapesandcolour.com.au
+61 02 6232 6582 / +61 04 1728 9042

CLIENT

CANBERRA GRAMMAR SCHOOL

DRAWING TITLE
DRAWING USE

PROJECT
PROJECT NUMBER

DWG NO
REVISION

COVER PAGE
FOR APPROVAL

CGS ROWING SHED, YARRALUMLA, BLOCK 3 & SECTION 19
18_006

L.000 COVER
A

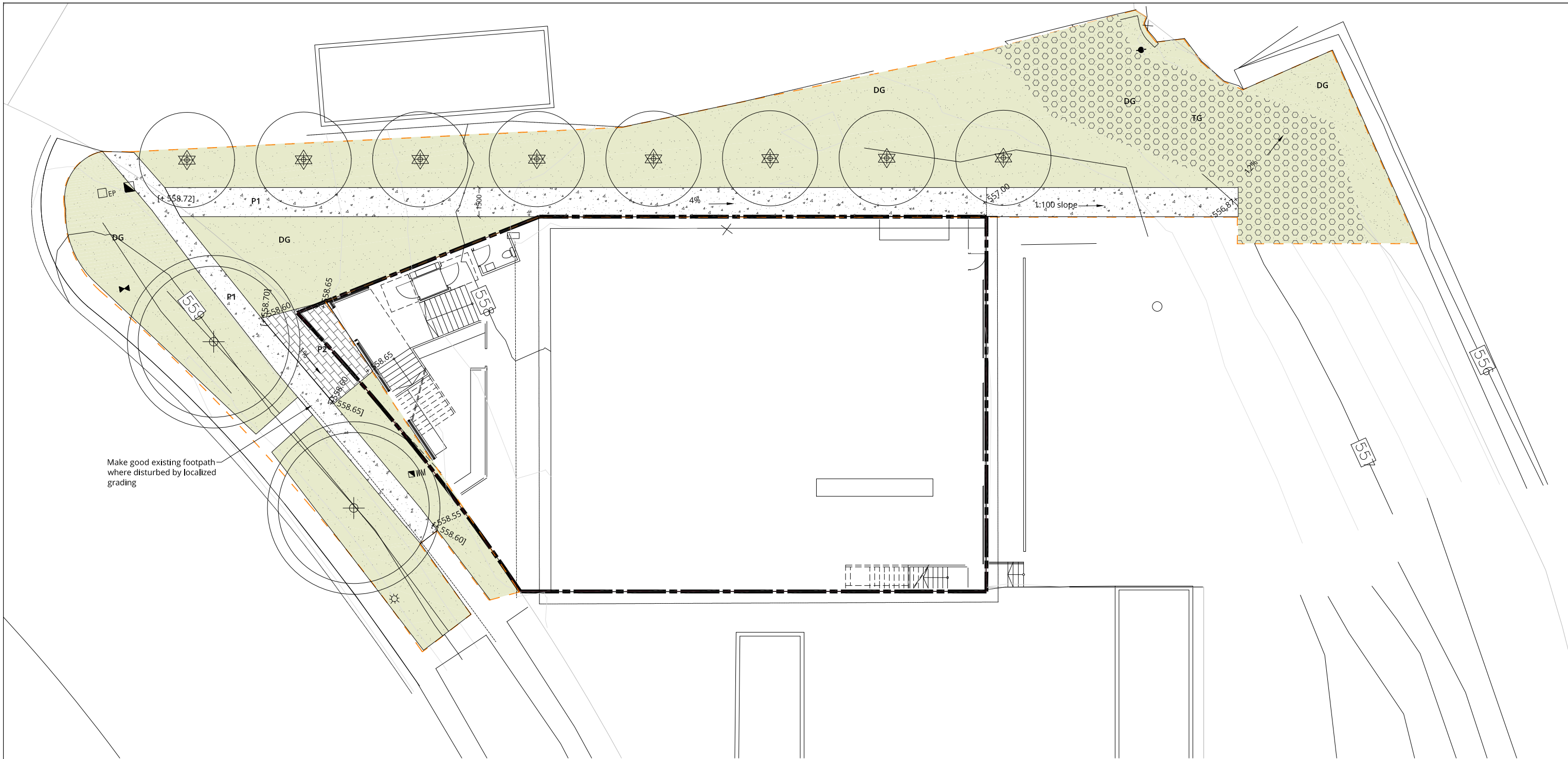

LEGEND

- SITE BOUNDARY
- EXTENT OF LANDSCAPE WORKS
- ROOT CONTROL BARRIER
As shown. Refer to street tree table for standard offset requirements. Root control barrier (300mm deep against footpaths and 450mm deep against kerbs).
- EXISTING MAJOR CONTOURS
1M intervals
- EXISTING MINOR CONTOURS
250mm intervals

- PAVING TYPE 1**
Material: Concrete
Finish: Non-slip
- PAVING TYPE 2**
Material: Saw Cut Concrete
Finish: Light abrasive blast. Non-slip finish
- TRAFFICABLE GRASS**
SUREPAVE or equivalent product to be installed to reinforce and stabilise grass surface
- DRYLAND GRASS**
100mm depth imported topsoil Type C and cultivated subgrade. Sown with dryland grass mix all as specified. Where grass adjoins base of walls and edge of shrub beds provide mower strip as detailed

PROPOSED TREES

- Gleditsia tricanthos* 'Continental'
- Casuarina cunninghamiana*

CGS ROWING SHED TREE SCHEDULE								
CODE	SPECIES	MATURE SIZE (HxW)	POT SIZE	MIN HEIGHT	MIN CALLIPER	KERB OFFSET	PATH OFFSET	NUMBER
Csc	<i>Casuarina cunninghamiana</i>	18x10	45L	1.2m	30mm	1.85m	1.5m	2
Glc	<i>Gleditsia tricanthos</i> 'Continental'	9x5	100L	2.5m	40mm	NA	1.5m	8

NOTE: The contractor shall review plant schedule to ensure that drawings and schedules concur. Wherever discrepancies may exist the greater number & size as indicated on the drawings shall take precedence over the plant schedule. Install root control barrier (300mm deep against footpaths and 450mm deep against kerbs).

NOT FOR CONSTRUCTION

REVISION	DATE	AMENDMENT	DRAWN	CHECKED	APPROVED
A	28.03.2018	FOR APPROVAL-DRAFT	BC	RS	CF

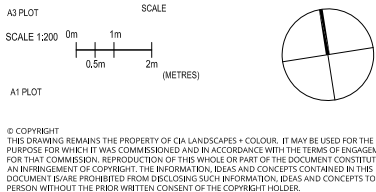

Cia
landscapes
+
colour

36 Mildura Street Fyshwick ACT 2609
Po Box 75 Red Hill ACT 2603
cia**landscapesandcolour.com.au**
+61 02 6232 6582 / +61 04 1728 9042

CLIENT
CANBERRA GRAMMAR SCHOOL

DRAWING TITLE DRAWING USE	LANDSCAPE PLAN FOR APPROVAL
PROJECT PROJECT NUMBER	CGS ROWING SHED, YARRALUMLA, BLOCK 3 & SECTION 19 18_006
DWG NO REVISION	L.301 DRAFT

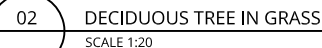

NOT FOR CONSTRUCTION

[illegible]

© COPYRIGHT
THIS DRAWING REMAINS THE PROPERTY OF CIA LANDSCAPES + COLOUR. IT MAY BE USED FOR THE PURPOSE FOR WHICH IT WAS COMMISSIONED AND IN ACCORDANCE WITH THE TERMS OF ENGAGEMENT FOR THAT COMMISSION. REPRODUCTION OF THIS WHOLE OR PART OF THE DOCUMENT CONSTITUTES AN INFRINGEMENT OF COPYRIGHT. THE INFORMATION, IDEAS AND CONCEPTS CONTAINED IN THIS DOCUMENT IS/ARE PROHIBITED FROM DISCLOSING SUCH INFORMATION, IDEAS AND CONCEPTS TO ANY PERSON WITHOUT THE PRIOR WRITTEN CONSENT OF THE COPYRIGHT HOLDER.

**Cia
landscapes
+
colour**

cialandscapesandcolour.com.au
+61 02 6232 6582 / +61 04 1728 9042

L.801
A