

THE FOOTHILLS, 30 LIMESTONE AVENUE

BLOCK 4 & 5 SECTION 38 CAMPBELL

LANDSCAPE WORKS APPROVAL

DATE: MARCH 2020

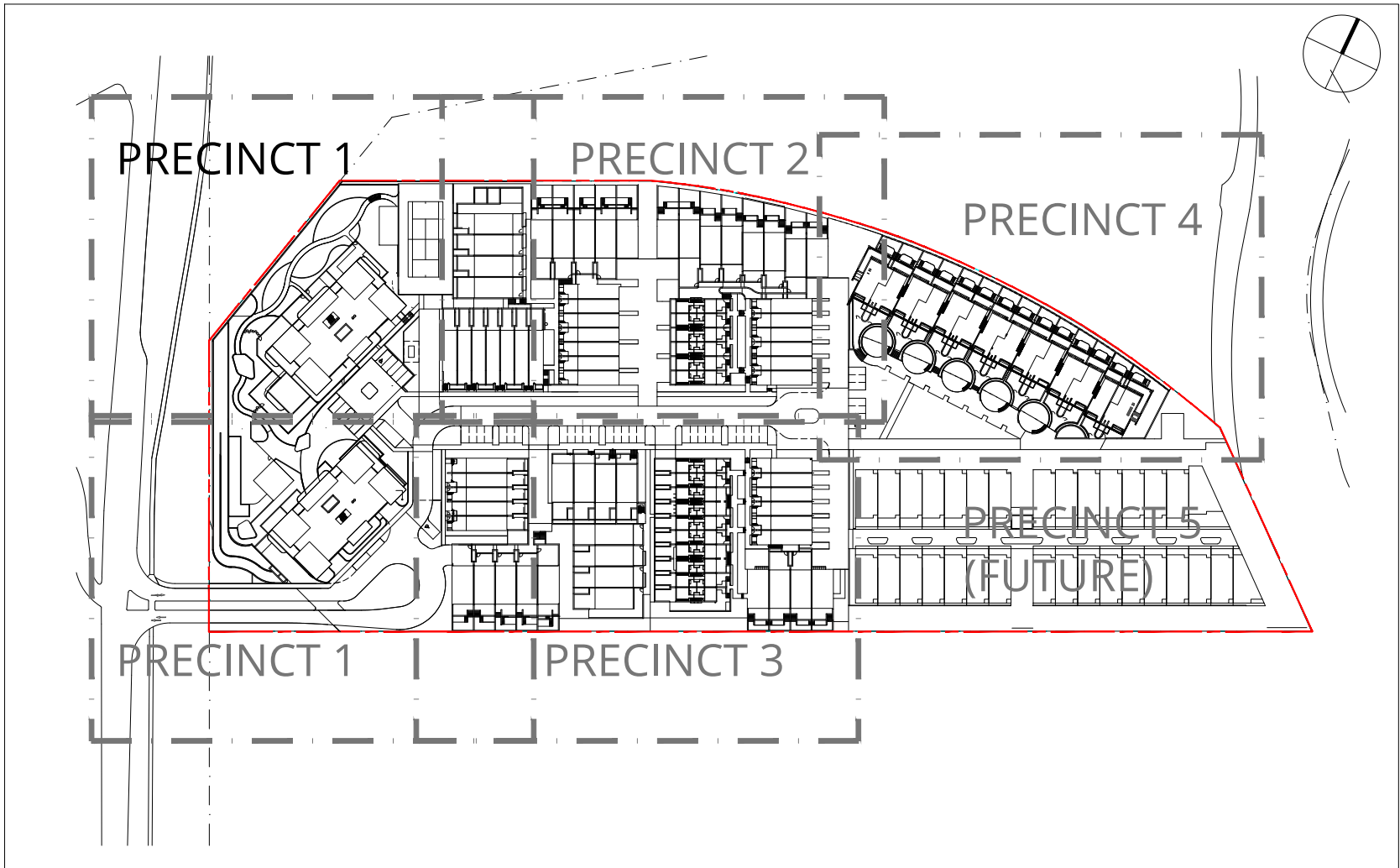

SHEET PLAN 1:1000

DRAWING SCHEDULE	
L-000	Cover Sheet
L-001	Plant Schedule
PRECINCT 1	
L-P1-301	Ground Level - General Arrangement and Planting Plan - Sheet 1
L-P1-302	Ground Level - General Arrangement and Planting Plan - Sheet 2
PRECINCT 2	
L-P2-303	General Arrangement and Planting Plan
PRECINCT 3	
L-P3-304	General Arrangement and Planting Plan
PRECINCT 4	
L-P4-305	General Arrangement and Planting Plan

PLANT SCHEDULE

CODE	SPECIES	NUMBER	HT x WIDTH	SPACINGS	POTSIZE
NATIVE EVERGREEN TREES					
ACv	Allocasuarina verticillata	14	6 x 4m	As shown	45 Lt
BNI	Banksia integrifolia	14	6 x 4m	As shown	45 Lt
Eld	Eucalyptus leucoxylon Euky Dwarf	15	6 x 5m	As shown	1m high spring ring
Emf	Eucalyptus mannifera 'Little Spotty'	21	7 x 7m	As shown	1m high spring ring
EpL	Eucalyptus pauciflora 'Little Snowman'	41	4-7 x 3-5m	As shown	1m high spring ring
NATIVE EVERGREEN TREES TO SOUTHERN PERIMETER					
Ebr	Eucalyptus bridgesiana	7	find	As shown	1m high spring ring
Ebl	Eucalyptus blakelyi	3	20 x 15m	As shown	1m high spring ring
Eru	Eucalyptus rossii	8	15 x 10-15m	As shown	1m high spring ring

NATIVE SHRUBS

AcI	Acacia cognata Limelight	4	0.6 x 1m	As shown	140mm pot
BKI	Baeckea linifolia	15	1.75 x 2m	As shown	140mm pot
BNr	Banksia robur	38	2 x 1.5m	As shown	140mm pot
Cpa	Callistemon pallidus	4	3 x 3m	As shown	140mm pot
Cvb	Callistemon viminalis 'Better John'	190	0.6 x 0.6m	4 per m2 or 2 per lin m	140mm pot
Cvg	Callistemon viminalis 'Green John'	94	0.6 x 0.6m	4 per m2 or 2 per lin m	140mm pot
Cvs	Callistemon viminalis 'Slim'	54	3 x 1.3m	1.5 per lin m	140mm pot
CRa	Correa alba	30	1.5 x 1.5m	As shown	140mm pot
CRdb	Correa 'Dusky Bells'	27	0.5x.75	3 per m2	140mm pot
CRg	Correa glabra 'Ivory Lantern'	74	0.6 x 0.6m	3 per m2	140mm pot
CWg	Crowea exalata Ginninderra Falls	10	0.5 x 0.5m	3 per m2	140mm pot
Grg	Grevillea Robyn Gordon	67	1.5 x 2m	As shown	140mm pot
Lah	Leptospermum 'Aphrodite'	7	2.5 x 2m	As shown	140mm pot
Pmm	Philotheca myoporoides subsp. myoporoides	27	1.5 x 2m	As shown	140mm pot
WEg	Westringia fruticosa 'Grey Box'	534	0.4 x 0.4m	4 per m2 or 3 per lin m	140mm pot
WEn	Westringia 'Naringa'	46	1.2 - 2 x 0.6 - 1.5m	2 per lin m	140mm pot

NATIVE GROUNDCOVERS

Cgc	Casuarina glauca 'Cousin It'	389	0.15 x 1 m	2 per m2	140mm pot
Dlj	Dianella caerulea 'Little Jess'	67	0.4 x 0.4m	5 per m2	viirotube
Dir	Dianella revoluta 'Revelation'	238	0.5 x 0.5m	5 per m2	viirotube
DHr	Dichondra repens	345	0.1 x	9 per m2	tube stock
Hap	Chrysocephalum apiculatum 'Desert Flame'	57	0.15 x 0.5m	5 per m2	140mm pot
Gbr	Grevillea Bronze Rambler	131	0.3 x 3m	1 per m2	140mm pot
Gla	Grevillea lanigera 'Mt Tamboritha	79	0.4 m x 1 - 2 m	2 per m2	140mm pot
LDk	Lomandra longifolia 'Katrinus Deluxe'	204	0.7 x 0.7m	4 per m2	viirotube
LDt	Lomandra longifolia 'Tanika'	571	0.5 x 0.65m	5 per m2	viirotube
Myp	Myoporum parvifolium 'Yareena'	138	0.1 x 1 m	2 per m2	140mm pot
POAe	Poa labillardieri 'Eskdale'	1025	0.6 x 0.5m	5 per m2	viirotube
RHs	Rhagodia spinescens 'Aussie Flat Bush'	370	0.3-0.5 x 1 m	2 per m2	140mm pot
WEf	Westringia fruticosa Low Horizon	387	0.3 x 0.7m	3 per m2	140mm pot

EXOTIC DECIDUOUS TREES

Ac	Acer rubrum 'Fairview Flame'	17	11 x 7m	As shown	100 Lt
Ac	Acer palmatum Senkaki	27	6 x 5m	As shown	100 Lt
LA	Lagerstroemia indica x fauriei 'Natchez'	23	6 x 4m	As shown	100 Lt
MG	Magnolia x soulangeana 'Vulcan'	8	6 x 4m	As shown	100 Lt
PL	Platanus orientalis Digitata	3	18 x 12m	As shown	100 Lt
PY	Pyrus calleryana 'Capital'	25	11 x 2-3m	As shown	100 Lt
PY	Pyrus calleryana 'Cleveland Select'	19	11 x 6m	As shown	100 Lt
U	Ulmus parvifolia Todd	26	10 x 11m	As shown	100 Lt
U	Ulmus sapporo Autumn Gold	6	12 x 8m	As shown	100 Lt
Z	Zelkova serrata Green Vase	6	14 x 10m	As shown	100 Lt

EXOTIC EVERGREEN TREES

ARu	Arbutus unedo	8	5 x 4m	As shown	45 Lt
CDa	Cordyline australis	26	5 x 2m	As shown	300mm
MGg	Magnolia grandiflora 'Little Gem'	48	6 x 3m	As shown	45 Lt

EXOTIC SHRUBS

Bsy	Beschorneria yuccoides	12	1 x 2m	As shown	200mm pot
BMa	Bambusa Alphonse Karr	50	1 -2 m H	As shown	300mm pot
CAMs	Camellia sasanqua	36	4 x 3m	1m cts	200mm pot
CAMa	Camellia sasanqua Slimline Avalanche	53	2 x 1m	0.9m cts	200mm pot
CTh	Cephalotaxus harringtonia 'Fastigiata'	80	2 x 1m	0.75m cts	200mm pot
CYt	Choisya ternata	76	1.5 x 1.5m	900mm cts	200mm pot
CVC	Convolvulus cneorum	33	0.5 x 0.5m	600mm cts	200mm pot
COa	Cornus alba sabrica	15	1.2 x 1m	900mm cts	200mm pot
CYr	Cycas revoluta	117	1.5 x 1.5m	1m cts or as shown	200mm pot
Dig	Dietes grandiflora Grand Star	24	0.6 x 0.6m	5 per m2 or 2 per lin m	200mm pot
Hab	Hebe albicans	64	0.6 x 0.9m	4 per m2	200mm pot
Hsn	Hebe snowdrift	49	1.5 x 1.5m	900mm cts	200mm pot
LmA	Liriope muscari Amethyst	449	0.4 x 0.4m	8 per m2	tube stock
LNn	Lonicera nitida	159	1 x 1m	300mm cts	200mm pot
Mfi	Michelia figo	79	3 x 2m	900mm cts	200mm pot
NNd	Nandina domestica	186	1.7 x 1m	900mm cts	200mm pot
TRf	Teurailum fruticans	40	1.2 x 1.2m	900mm cts	140mm pot
VBd	Viburnum davidii	60	1.2 x 1.2m	900mm cts	200mm pot

EXOTIC GROUNDCOVERS

Ats	Artemisia schmidtiana Nana	82	0.15 x 0.3m	7 per m2	140mm pot
Fgl	Festuca glauca 'Elijah Blue'	80	0.2 x 0.3m	300mm cts	tube stock
HDc	Hedera canariensis	1325	0.2 x	3 per m2	tube stock
JNh	Juniperus wilsonii Blue Rug	379	0.1 x 2.5m	4 per m2	140mm pot
OPj	Ophiopogon japonicus nana	502	0.1 x 0.2m	9 per m2	tube stock
Lml	Liriope muscari Isabella	545	0.4 x 0.5m	8 per m2	tube stock
Lmp	Liriope muscari Pink Pearl	926	0.25 x 0.25	8 per m2	tube stock
TYS	Thymus seraphyllum 'alba	35	0.15 x 0.6m	6 per m2	140mm pot
TRa	Trachelospermum asiaticum 'Flat Mat'	670	0.3 x 3m	2 per m2	140mm pot

EXOTIC CLIMBERS

Flp	<i>Ficus pumila</i>	39		As shown	200mm pot
MUc	<i>Muehlenbeckia complexa</i>	39		As shown	200mm pot
Pqu	<i>Parthenocissus quinquefolia</i>	28		As shown	200mm pot

NOTE: The contractor shall review plant schedule to ensure that drawings and schedules concur. Wherever discrepancies may exist the greater number & size as indicated on the drawings shall take precedence over the plant schedule.

[illegible]

© COPYRIGHT
THIS DRAWING REMAINS THE PROPERTY OF CIA LANDSCAPES + COLOUR. IT MAY BE USED FOR THE PURPOSE FOR WHICH IT WAS COMMISSIONED AND IN ACCORDANCE WITH THE TERMS OF ENGAGEMENT FOR THAT COMMISSION. REPRODUCTION OF THIS WHOLE OR PART OF THE DOCUMENT CONSTITUTES AN INFRINGEMENT OF COPYRIGHT. THE INFORMATION, IDEAS AND CONCEPTS CONTAINED IN THIS DOCUMENT IS/ARE PROHIBITED FROM DISCLOSING SUCH INFORMATION, IDEAS AND CONCEPTS TO ANY PERSON WITHOUT THE PRIOR WRITTEN CONSENT OF THE COPYRIGHT HOLDER.

**Cia
landscapes
+
colour**

36 Mildura Street Fyshwick ACT 2609
Po Box 75 Red Hill
ACT 2603

clandscapeandcolour.com.au
+61 02 6232 6582 / +61 04 1728 9042

CLIENT

DOMA

DRAWING TITLE PLANT SCHEDULE

PROJECT
PROJECT NUMBER
DWG NO
REVISION

PLANT SCHEDULE

THE FOOTHILLS, 30 LIMESTONE AVENUE
BLOCK 4 & 5 SECTION 38 CAMPBELL
16_029
L-001
C

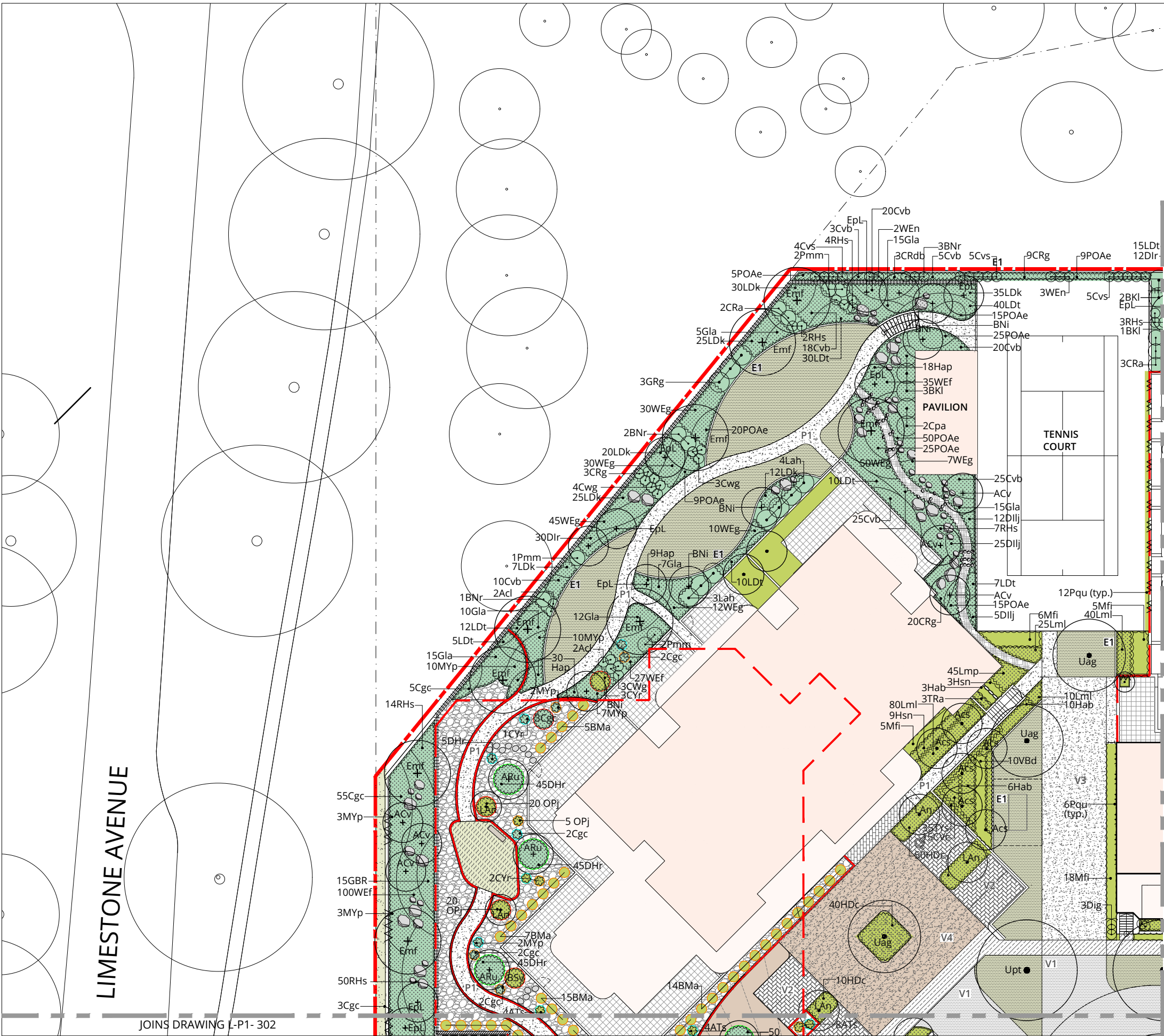

STEPS
Refer Architects drawings

EDGING TYPE 1
Material: Insitu plain concrete
Size: 150mm wide

EDGING TYPE 2
Material: Insitu plain concrete
Size: 150mm high x 150mm wide

SCREEN WALLS
To match Courtyard Walls
Refer Architects drawing

COURTYARD WALLS
Refer Architects drawing

FENCE AND GATES
Metal Flatbar Colour: Charcoal
Refer Architects drawings

POOL BALUSTRADE
Frameless Clear Glass
Refer Architects drawings

FEATURE STONE BOULDER
Material: On-site stone

INFORMAL ACCESS TRACK
Material: Wood mulch with site rock
informal steps

STEPPING STONES
Material: Sandstone crazy pavers
(Access from private courtyards)

PROPOSED POTS AND PLANTERS
PLANTER PB10
Steel planters equal to
Mascot Engineering PB10
Powder coated colour Charcoal
1m dia x 0.75m high.

PLANTER TYPE C1
Custom made steel planters
Powder coated colour Charcoal
1m dia x 0.5m high.

PLANTER TYPE C2
Custom made steel planters
Powder coated colour Charcoal
2m dia x 0.75m high.

PLANTER TYPE C3
Custom made steel planters
Powder coated colour Charcoal
3m dia x 1m high.

SITE FURNITURE
Shelter with Day beds

Umbrella Type 1
Heavy Duty Standard or similar.
(Colour to be selected).

Umbrella Type 2
Heavy Duty Cantilever or similar.
(Colour to be selected).

Pool shade structure

Seat Type 1
Material: Sandstone slab
(To seating decks and synthetic
grass areas)

NOTE:
Refer to Drawing L-001 for
Plant Schedule

KEY PLAN

SITE BOUNDARY

LINE OF BASEMENT UNDER

EXISTING TREES
To be retained

PROPOSED EVERGREEN TREES

PROPOSED DECIDUOUS TREES

MULCHED SHRUB BEDS
Predominately Exotic Species
Refer Plant Schedule

MULCHED SHRUB BEDS
Native Species
Refer Plant Schedule

PROPOSED HEDGE PLANTING

PROPOSED SHRUBS

PROPOSED GROUNDCOVER /
MASS PLANTING

PROPOSED TRAILING
GROUNDCOVERS / CLIMBERS
Refer Plant Schedule

IRRIGATED TURF
Laid to manufacturers specifications

DRYLAND GRASS

SYNTHETIC TURF

DECKING
Material: Natural colour or Mid Grey

PEBBLE MULCH
Material: Sandstone cobbles 50 to 80 dia.

POOL

PEDESTRIAN PAVING TYPE 1
Material: Off white concrete.
Broom finish

PEDESTRIAN PAVING TYPE 2
Material: Off white concrete, coloured aggregate.
Light shot blast finish

PEDESTRIAN PAVING TYPE 3
Material: Coloured Concrete CCS Lemon Grass,
coloured aggregate. Light shot blast finish with
sawcuts where shown

PEDESTRIAN PAVING TYPE 4
Material: Unit pavers light sandstone colour

PRIVATE COURTYARDS
Paving - Refer Architects Drawings

VEHICLE PAVING TYPE 1
Material: Asphalt

VEHICLE PAVING TYPE 2
Material: Unit Paving Colour Charcoal

VEHICLE PAVING TYPE 3
Material: Coloured Concrete CCS Steel
Broom Finish

VEHICLE PAVING TYPE 4
Material: Coloured Concrete CCS Lemon Grass
Broom Finish with sawcuts as shown

REVISION	DATE	AMENDMENT	DRAWN	CHECKED	APPROVED
A.	01.11.19	FOR APPROVAL	RES	CF	CF
B.	28.11.19	MINOR AMENDMENTS FOR APPROVAL	RES	CF	CF
C.	06.01.20	MINOR AMENDMENTS FOR APPROVAL	RES	CF	CF
D.	16.03.20	PAVEMENT TYPES AMENDED, PLANT NO. ADDED, POTS REDUCED	RES	CF	CF

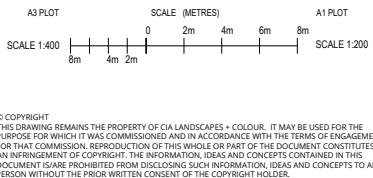

Cia
landscapes
+
colour

36 Mildura Street Fyshwick ACT 2609
Po Box 75 Red Hill
ACT 2603
cialandscapesandcolour.com.au
+61 02 6232 6382 / +61 04 1728 9042

CLIENT

DOMA

DRAWING TITLE

PRECINCT 1 / GROUND LEVEL
GENERAL ARRANGEMENT & PLANTING PLAN

PROJECT

THE FOOTHILLS, 30 LIMESTONE AVENUE
BLOCK 4 & 5 SECTION 38 CAMPBELL
16.029
L-P1-301 Sheet 1
D

PROJECT NUMBER
DWG NO
REVISION



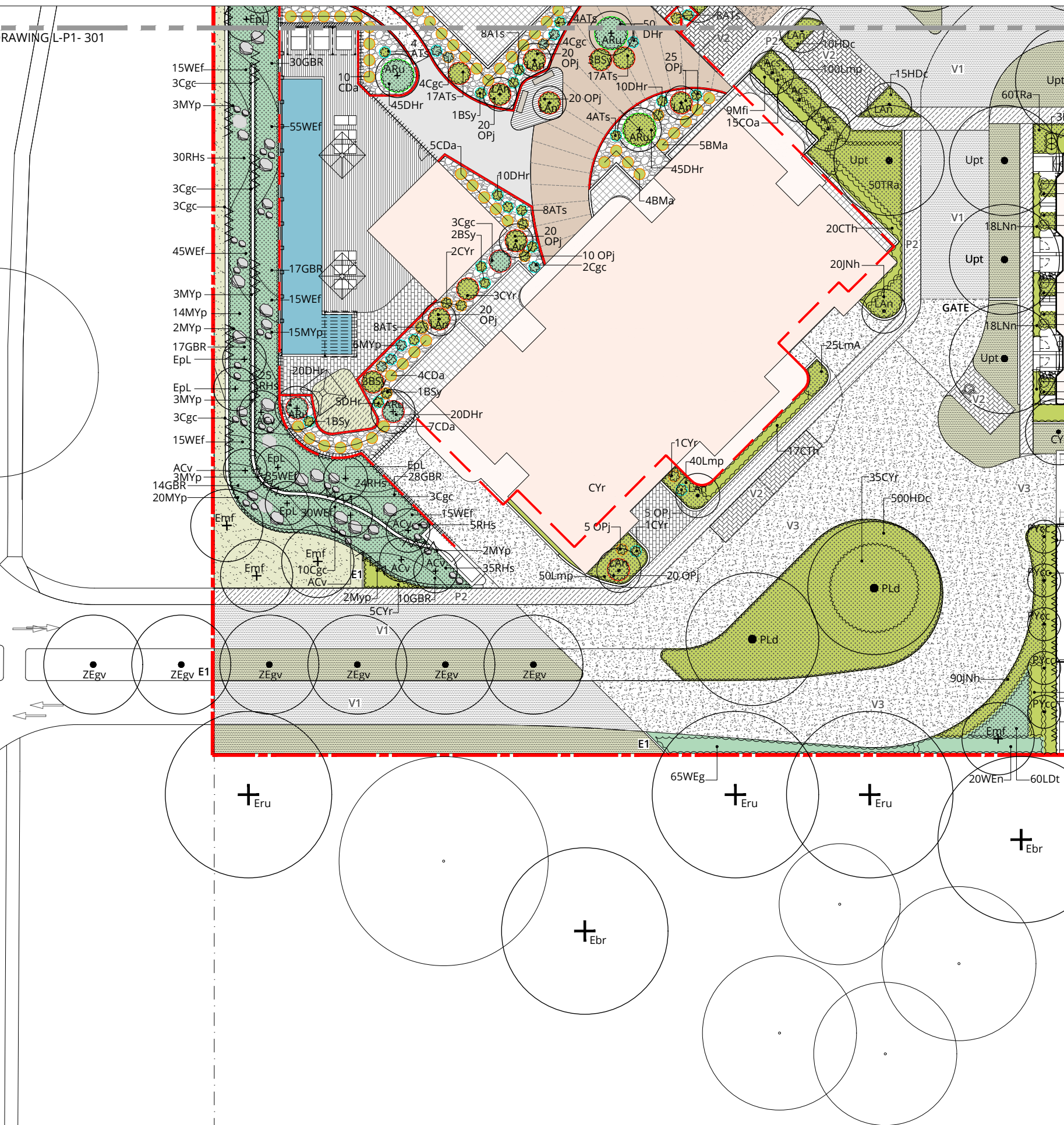

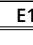
- 

STEPS
Refer Architects drawings
 - 

EDGING TYPE 1
Material: Insitu plain concrete
Size: 150mm wide
 - 

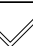
EDGING TYPE 2
Material: Insitu plain concrete
Size: 150mm high x 150mm wide
 - 

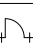
SCREEN WALLS
To match Courtyard Walls
Refer Architects drawing
 - 

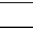
COURTYARD WALLS
Refer Architects drawing
 - 

FENCE AND GATES
Metal Flatbar Colour: Charcoal
Refer Architects drawings
 - 





POOL BALUSTRADE
Frameless Clear Glass
Refer Architects drawings
 - 

FEATURE STONE BOULDER
Material: On-site stone
 - 

INFORMAL ACCESS TRACK
Material: Wood mulch with site rock
informal steps
 - 

STEPPING STONES
Material: Sandstone crazy pavers
(Access from private courtyards)

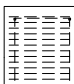
- JOINS DRAWING L-P3- 304**
- PROPOSED POTS AND PLANTERS**
- PLANTER PB10**
Steel planters equal to Mascot Engineering PB10
Powder coated colour Charcoal
1m dia x 0.75m high.
- PLANTER TYPE C1**
Custom made steel planters
Powder coated colour Charcoal
1m dia x 0.5m high.
- PLANTER TYPE C2**
Custom made steel planters
Powder coated colour Charcoal
2m dia x 0.75m high.
- PLANTER TYPE C3**
Custom made steel planters
Powder coated colour Charcoal
3m dia x 1m high.

- ## SITE FURNITURE
- Shelter with Day beds
- 
- Umbrella Type 1
Heavy Duty Standard or similar.
(Colour to be selected).
- 
- Umbrella Type 2
Heavy Duty Cantilever or similar.
(Colour to be selected).
- 
- Pool shade structure
- 
- Seat Type 1
Material: Sandstone slab
(To seating decks and synthetic grass areas)
- 

NOTE:
Refer to Drawing L-001 for
Plant Schedule

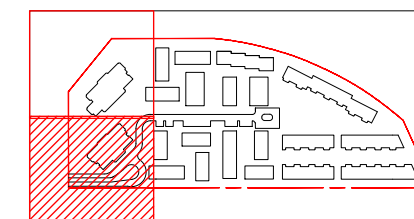

KEY PLAN

- | | |
|---------------|--|
| LEGEND | |
| | SITE BOUNDARY |
| | LINE OF BASEMENT UNDER |
| | EXISTING TREES
To be retained |
| | PROPOSED EVERGREEN TREES |
| | PROPOSED DECIDUOUS TREES |
| | MULCHED SHRUB BEDS
Predominately Exotic Species
Refer Plant Schedule |
| | MULCHED SHRUB BEDS
Native Species
Refer Plant Schedule |
| | PROPOSED HEDGE PLANTING |
| | PROPOSED SHRUBS |
| | PROPOSED GROUNDCOVER / MASS PLANTING |
| | PROPOSED TRAILING GROUNDCOVERS / CLIMBERS
Refer Plant Schedule |
| | IRRIGATED TURF
Laid to manufacturers specifications |
| | DRYLAND GRASS |
| | SYNTHETIC TURF |
| | DECKING
Material: Natural colour or Mid Grey |
| | PEBBLE MULCH
Material: Sandstone cobbles 50 to 80 dia. |
| | POOL |
| | PEDESTRIAN PAVING TYPE 1
Material: Off white concrete.
Broom finish |
| | PEDESTRIAN PAVING TYPE 2
Material: Off white concrete, coloured aggregate.
Light shot blast finish |
| | PEDESTRIAN PAVING TYPE 3
Material: Coloured Concrete CCS Lemon Grass, coloured aggregate. Light shot blast finish with sawcuts where shown |
| | PEDESTRIAN PAVING TYPE 4
Material: Unit pavers light sandstone colour |
| | PRIVATE COURTYARDS
Paving - Refer Architects Drawings |
| | VEHICLE PAVING TYPE 1
Material: Asphalt |
| | VEHICLE PAVING TYPE 2
Material: Unit Paving Colour Charcoal |
| | VEHICLE PAVING TYPE 3
Material: Coloured Concrete CCS Steel Broom Finish |
| | VEHICLE PAVING TYPE 4
Material: Coloured Concrete CCS Lemon Grass Broom Finish with sawcuts as shown |

REVISION	DATE	AMENDMENT	DRAWN	CHECKED	APPROVED
A	01.11.19	FOR APPROVAL	RES	CF	CF
B	28.11.19	MINOR AMENDMENTS FOR APPROVAL	RES	CF	CF
C	06.01.20	MINOR AMENDMENTS FOR APPROVAL	RES	CF	CF
D	16.03.20	PAVEMENT TYPES AMENDED, PLANT NO. ADDED, POTS REDUCED	RES	CF	CF

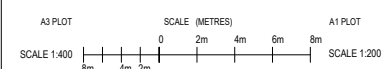

© COPYRIGHT
THIS DRAWING REMAINS THE PROPERTY OF CIA LANDSCAPES + COLOUR. IT MAY BE USED FOR THE PURPOSE FOR WHICH IT WAS COMMISSIONED AND IN ACCORDANCE WITH THE TERMS OF ENGAGEMENT. FOR THAT COMMISSION, REPRODUCTION OF THIS WHOLE OR PART OF THE DOCUMENT CONSTITUTES AN INFRINGEMENT OF COPYRIGHT, THE INFORMATION, IDEAS AND CONCEPTS CONTAINED IN THIS DOCUMENT IS/ARE PROHIBITED FROM DISCLOSING SUCH INFORMATION, IDEAS AND CONCEPTS TO ANY PERSON WITHOUT THE PRIOR WRITTEN CONSENT OF THE COPYRIGHT HOLDER.

**Cia
landscapes
+
colour**

**36 Mildura Street Fyshwick ACT 2609
Po Box 75 Red Hill
ACT 2603**

clandscapeandcolour.com.au
+61 02 6232 6582 / +61 04 1728 9042

CLIENT

DOMA

PRECINCT 1 / GROUND LEVEL
GENERAL ARRANGEMENT & PLANTING PLAN

THE FOOTHILLS, 30 LIMESTONE AVENUE
BLOCK 4 & 5 SECTION 38 CAMPBELL

16_029
L-P1-302 Sheet 2
D

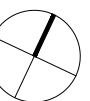

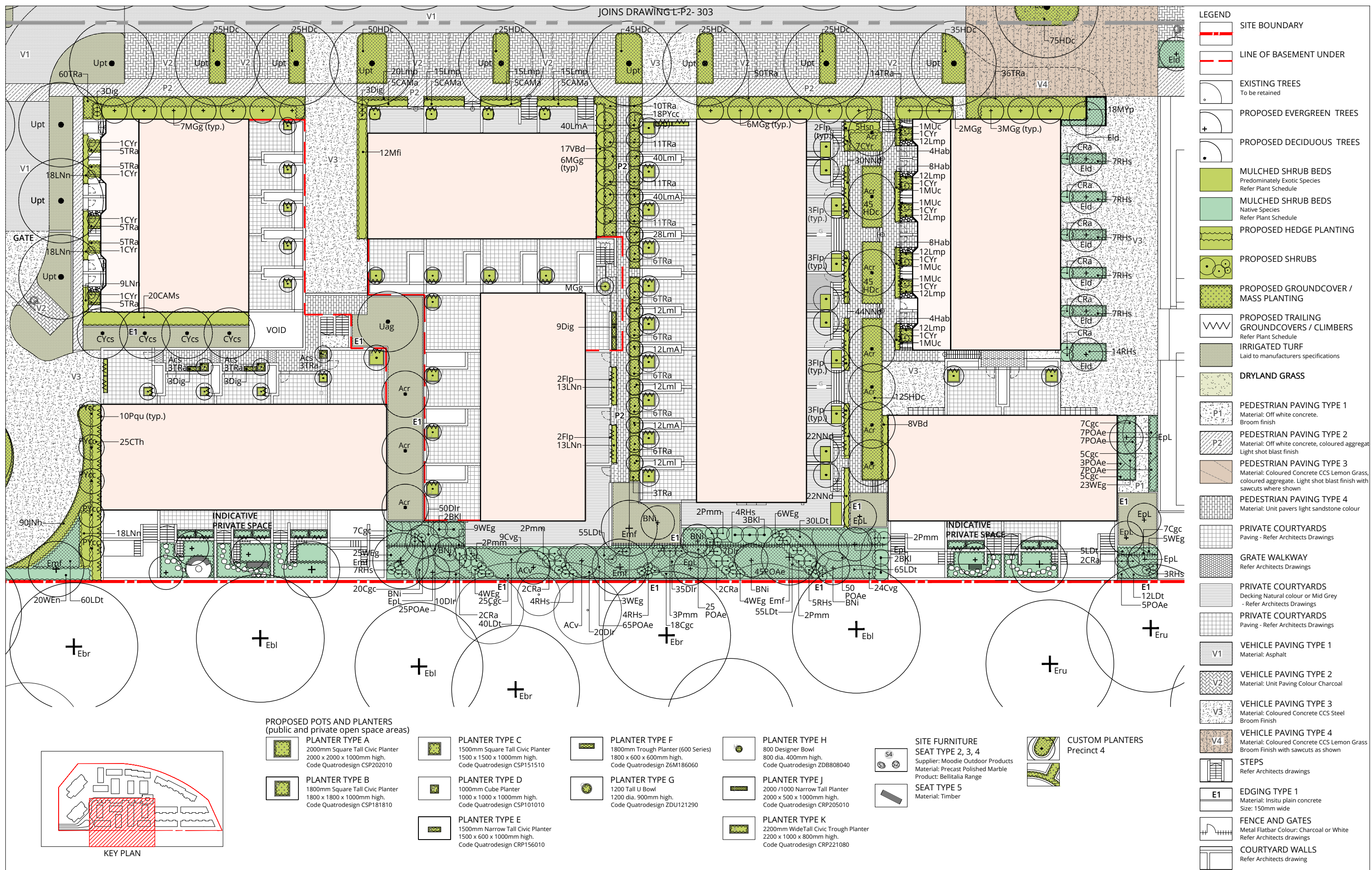

REVISION	DATE	AMENDMENT	DRAWN	CHECKED	APPROVED
A	01.11.19	FOR APPROVAL	RES	CF	CF
B	04.11.19	LEGEND AMENDED, FOR APPROVAL	RES	CF	CF
C	06.11.19	MINOR AMENDMENTS, FOR APPROVAL	RES	CF	CF
D	19.12.19	MINOR AMENDMENTS, FOR APPROVAL	RES	CF	CF
E	16.03.20	PAVEMENT TYPES AMENDED, PLANT NO. ADDED	RES	CF	CF

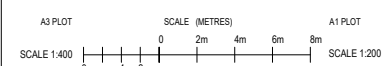

© COPYRIGHT
THIS DRAWING REMAINS THE PROPERTY OF CIA LANDSCAPES + COLOUR. IT MAY BE USED FOR THE
PURPOSE FOR WHICH IT WAS COMMISSIONED AND IN ACCORDANCE WITH THE TERMS OF ENGAGEMENT
FOR THAT COMMISSION. REPRODUCTION OF THIS WHOLE OR PART OF THE DOCUMENT CONSTITUTE
AN INFRINGEMENT OF COPYRIGHT. THE INFORMATION, IDEAS AND CONCEPTS CONTAINED IN THIS
DOCUMENT IS/ARE PROHIBITED FROM DISCLOSING SUCH INFORMATION, IDEAS AND CONCEPTS TO
A PERSON WITHOUT THE PRIOR WRITTEN CONSENT OF THE COPYRIGHT HOLDER.

**Cia
landscapes
+
colour**

**36 Mildura Street Fyshwick ACT 2609
Po Box 75 Red Hill
ACT 2603**

cl@landscapesandcolour.com.au
+61 02 6232 6582 / +61 04 1728 9042

CLIENT

DOMA

DRAWING TITLE

PROJECT

PROJECT NUMBER
DWG NO
REVISION

PRECINCT 3

GENERAL ARRANGEMENT & PLANTING PLAN

THE FOOTHILLS, 30 LIMESTONE AVENUE
BLOCK 4 & 5 SECTION 38 CAMPBELL
16_029
L-P3-304
E

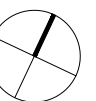

TREES

BOUNDARY / INFILTRATION

NATIVE EVERGREEN TREES



Allocasuarina verticillata



Banksia integrifolia



Eucalyptus leucoxydon
'Euky Dwarf'



Eucalyptus mannifera
'Little Spotty'

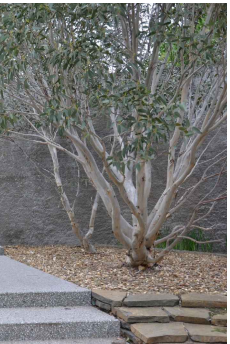

Eucalyptus pauciflora
'Little Snowman'

AVENUES

EXOTIC DECIDUOUS TREES



Ulmus parvifolia 'Todd'



Zelkova serrata
'Green Vase'

FEATURE

EXOTIC DECIDUOUS TREES



Platanus orientalis
'Digitata'



Ulmus sapporo
'Autumn Gold'

INTERNAL AREAS

EXOTIC EVERGREEN TREES



Magnolia Little Gem

EXOTIC DECIDUOUS TREES

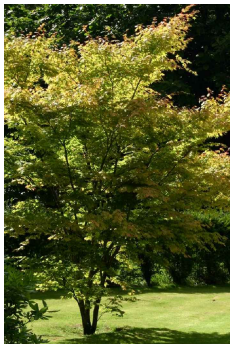

Acer palmatum 'Senkaki'



Acer rubrum
'Fairview Flame'



Magnolia soulangeana



Pyrus species

PODIUM AREA PLANTING

TREES

EXOTIC EVERGREEN TREES



Arbutus unedo



Cordyline australis

EXOTIC DECIDUOUS TREES



Lagerstroemia indica
'Natchez'

SHRUBS
EXOTIC

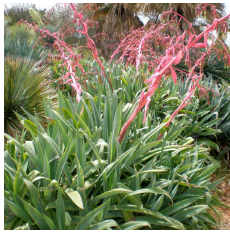

Beschorneria yuccoidese



Bambusa Alphonse Karr



Cycas revoluta

GROUNDCOVERS

EXOTIC



Artemisia schmidtiana Nana



Ophiopogon
japonicus nana

NATIVE



Casuarina glauca 'Cousin It'

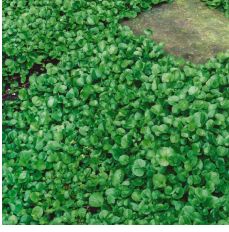

Dichondra repens

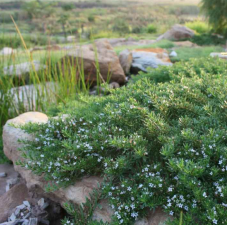

Myoporum parvifolium
'Yareena'

NATIVE BOUNDARY / INFILTRATION AREAS

SHRUBS



SHRUBS



Philotheca myoporoides subsp. myoporoides



Westringia varieties

GROUNDCOVERS

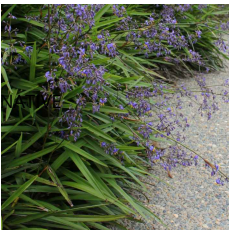

Dianella varieties



Chrysocephalum apiculatum 'Desert Flame'



Grevillea Bronze Rambler



Grevillea lanigera 'Mt Tamboritha'



Lomandra longifolia 'Katrinus Deluxe'



Lomandra longifolia 'Tanika'



Poa labillardieri 'Eskdale'



Rhagodia spinescens 'Aussie Flat Bush'



Westringia fruticosa 'Low Horizon'

EXOTIC INTERNAL AREAS

SHRUBS



Camellia sasanqua varieties



Cephalotaxus harringtonia 'Fastigiata'



Choisya ternata



Convolvulus cneorum



Cornus alba sabrica

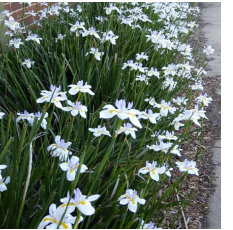

Dietes grandiflora 'Grand Star'



Hebe albicans



Hebe snowdrift



Liriope muscari Amethyst



Lonicera nitida

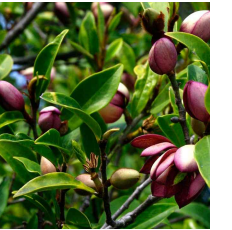

Michelia figo

SHRUBS



Nandina domestica



Teurailum fruticans

GROUNDCOVERS



Viburnum davidii



Festuca glauca 'Elijah Blue'

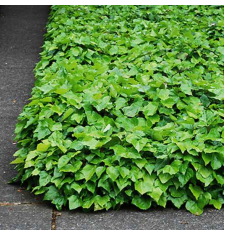

Hedera canariensis



Juniperus wiltonii Blue Rug



Liriope muscari Isabella



Liriope muscari Pink Pearl

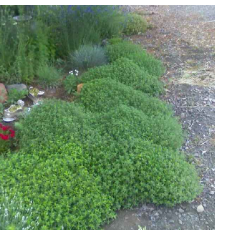

Thymus seraphyllum 'alba'



Trachelospermum asiaticum 'Flat Mat'

CLIMBERS



Ficus pumila



Muehlenbeckia complexa



Parthenocissus quinquefolia