

The development concept proposes buildings fronting Limestone Avenue to a height that does not cause overshadowing; consistent with the proposed DCP Urban Design Principle 4 - ensuring that buildings do not cast a shadow encroaching Sections 11 or 18 Reid at 9.30am on the 21st of June.

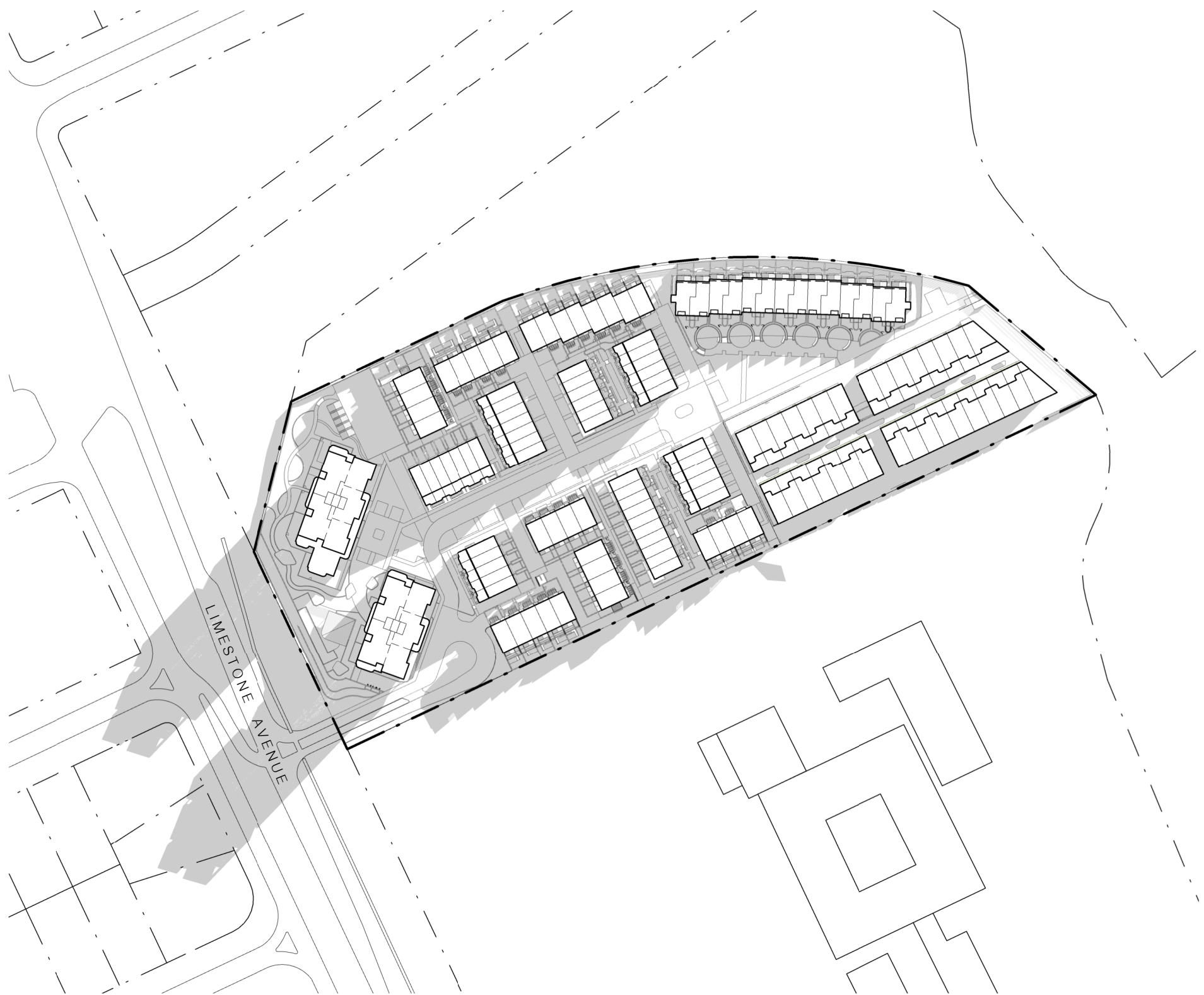

WINTER SOLSTICE 9am

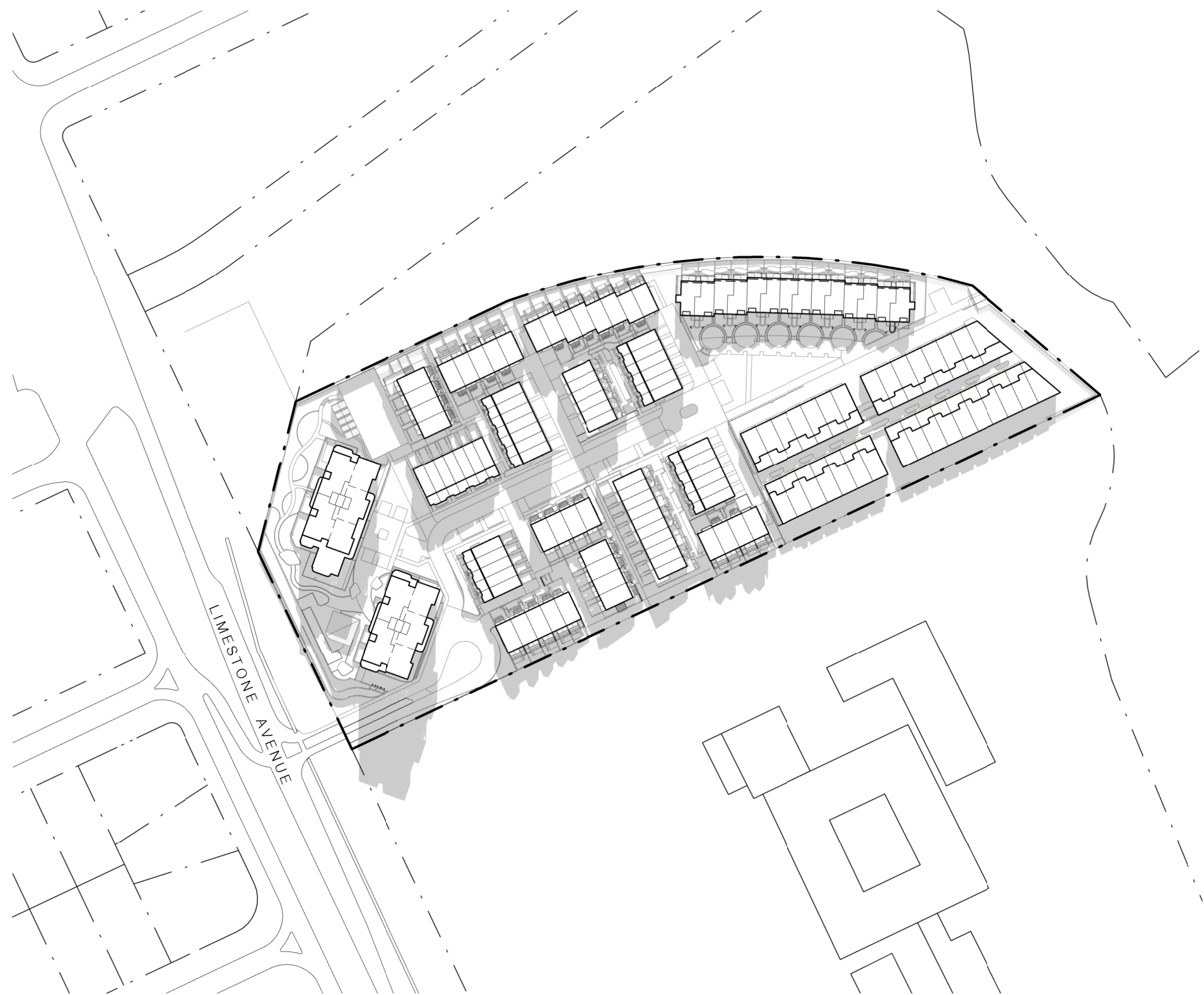

WINTER SOLSTICE 12pm

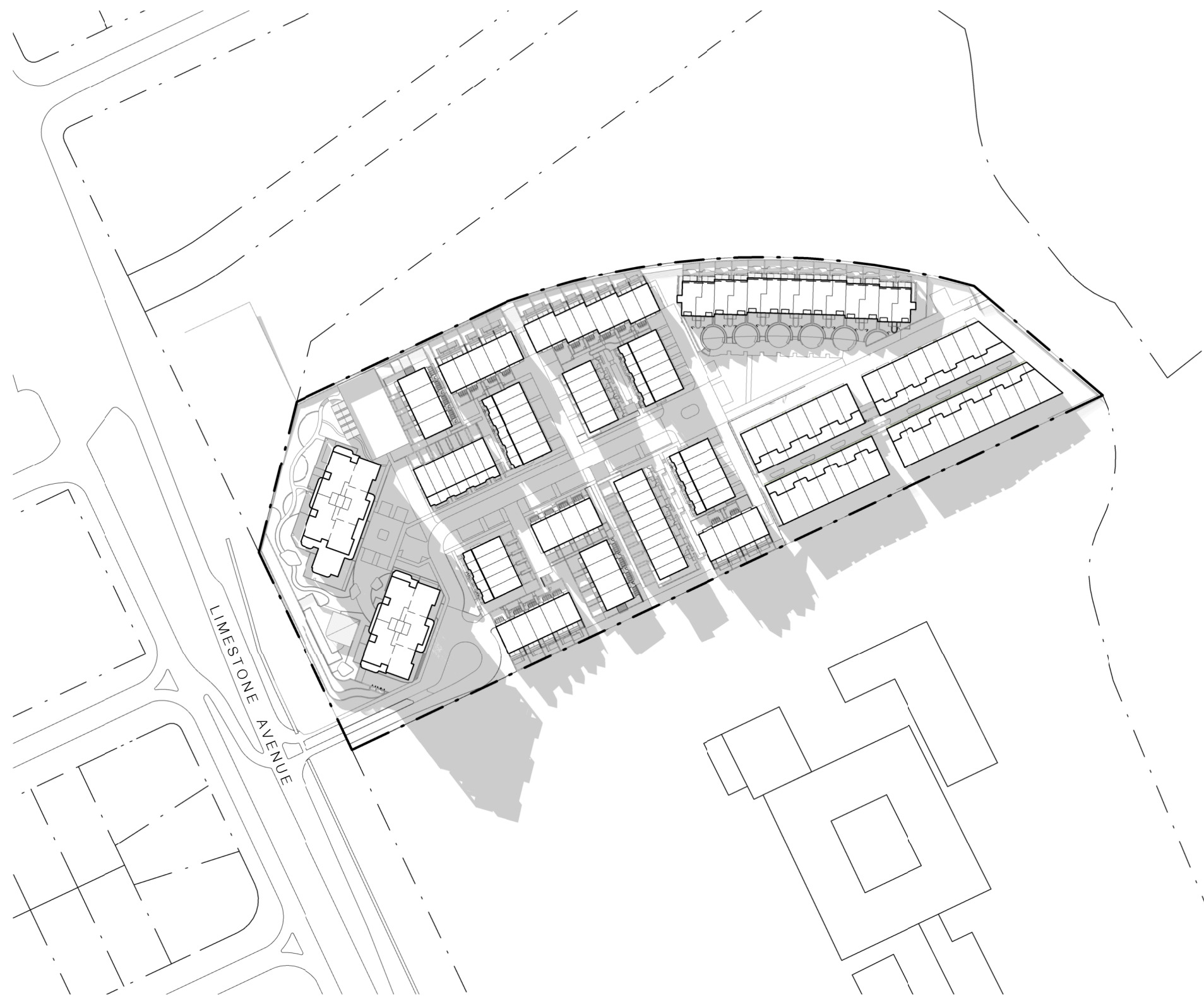

WINTER SOLSTICE 3pm

REV	DESCRIPTION
A	ISSUE FOR WORKS APPROVAL

DATE
15.01.2020

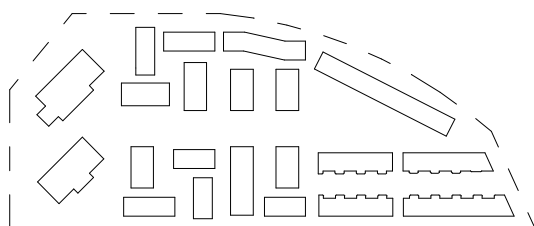

DOMA

STEWART
ARCHITECTURE

36 MILDURA STREET Fyshwick 3099
PO BOX 3469 MANUKA ACT 2603
OFFICE@STEWARTARCHITECTURE.COM.AU

PROJECT **THE FOOTHILLS**
BLOCKS 4 & 5 SECTION 38 CAMPBELL
PROJECT No. **1624**

DRAWING No. **WA0 - 035**
DRAWING TITLE **PLAN - SHADOW DIAGRAMS**
SCALE **1 : 2000 @ A1**
DATE **2020**

